

Legend

- State Route
- County Road
- Local Road
- Parcels
- Municipal Boundary

Zoning District

- RR
- RC-1
- RC-2
- ORI
- RB
- R-M

- SHEET INDEX:**
1. SITE PLAN
 2. GRADING PLAN
 3. DRAINAGE PLAN
 4. UTILITY PLAN
 5. SOIL EROSION & SEDIMENT CONTROL PLAN
 6. DETAILS SHEET

BULK REQUIREMENTS 15 SEARS ROAD SBL: 216-1-16 LOTS 1 & 2 (ZONE RB) RESIDENCE B DISTRICT

BULK TABLE:

	REQUIRED	EXISTING	BUILDING #	
			PROVIDED	PROVIDED
MINIMUM:				
LOT AREA	10000	24119.00	24119.00	24119.00
FRONTAGE	50	200	200.00	200.00
FRONT YARD (SEARS RD.)	40	43	40.00	42.00
FRONT YARD (SEARS RD.)	N/A	N/A	N/A	40.00
REAR YARD	40	58	40.00	N/A
SIDE YARD (ONE)	15	59	15.00	15.00
SIDE YARD (BOTH)	30	139	30.00	N/A
MAXIMUM:				
BUILDING COVERAGE	50%	12.48%	21%	0%
BUILDING HEIGHT/STORIES	2.5 STORIES	>2.5 STORIES	>2.5 STORIES	>2.5 STORIES
PARKING:				
PARKING SPACES	4 (2 PER UNIT)	2	4 (2 PER UNIT)	4 (2 PER UNIT)

PLANNING BOARD SIGNATURE

PLANNING BOARD CHAIRMAN _____ SIGNATURE DATE _____

THIS IS TO CERTIFY THAT THIS SITE PLAN DATED _____ HAS BEEN APPROVED BY THE PLANNING BOARD BY A RESOLUTION OF APPROVAL DATED _____

HEREBY CONSENT TO THE FILING OF THIS SITE PLAN INCLUDING ALL DESIGN CONCEPTS, NOTES, STIPULATIONS AND OTHER INFORMATION INDICATED THEREON.

- NOTES:**
1. BOUNDARY AND TOPOGRAPHY TAKEN FROM SURVEY BY EDWARD T. GANNON P.L.S. LIC# 24208, DATED 05. 01. 2024.
 2. THE HORIZONTAL AND VERTICAL LOCATION OF EXISTING SUBSURFACE UTILITIES HAVE BEEN DETERMINED FROM DATA PROVIDED BY OTHERS. IT WILL BE THE RESPONSIBILITY OF THE CONTRACTOR TO PROTECT ALL EXISTING UTILITIES WITHIN THE AREA OF CONSTRUCTION THAT ARE TO REMAIN IN SERVICE. CONTRACTOR SHALL VERIFY SIZE AND LOCATION OF ALL UTILITIES PRIOR TO CONSTRUCTION.
 3. THE EXISTING GAS AND ELECTRIC UTILITIES MUST BE LOCATED AND MARKED BEFORE CONSTRUCTION CAN START.
 4. IT IS RECOMMENDED TO USE LEAF GUARD OR A SIMILAR PRODUCT ON ALL GUTTERS.
 5. FOR ALL UTILITY CONSTRUCTION & IMPROVEMENT, THE APPLICANT SHALL RESTORE ALL PAVEMENT, CURB, SIDEWALK, ETC. TO MATCH THE EXISTING CONDITIONS.

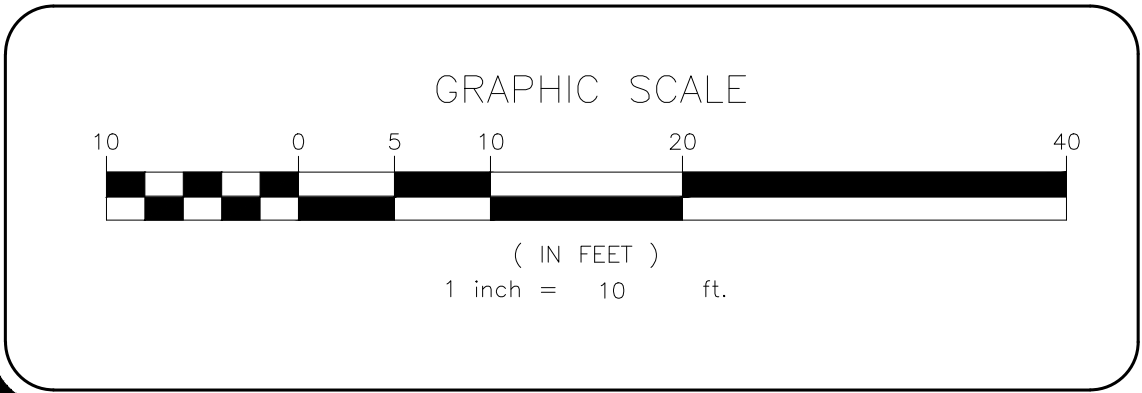

NO.	REVISION	DATE	DR/CK

KEVIN P. MAHER, P.E., M.ASCE
4 EDGEWOOD DRIVE
CENTRAL VALLEY, NY 10917
LIC. 065454
NY 845-666-0155
NJ 732-523-2289
E-MAIL INFO@TERRANVC.COM
5/28/2024

DocuSigned by:
 KEVIN P. MAHER, P.E., M.ASCE LIC. 065454 DATE

SITE PLAN

DESIGN BY:	DRAWN BY:	CHECKED BY:
YB	JM	KPM

15 SEARS
15 SEARS RD., VILLAGE OF SOUTH BLOOMING GROVE,
ORANGE COUNTY, NY 10950
SBL 216-1-16

DRAWING NUMBER:	SCALE:	FILE NO.:	DATE:
01 OF 07	1"=20'	24177	05/28/2024

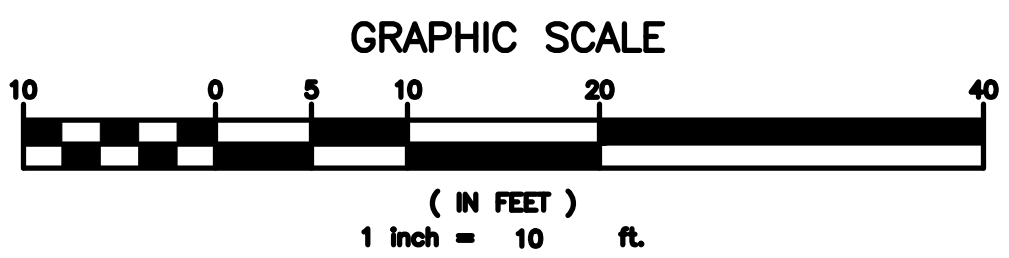
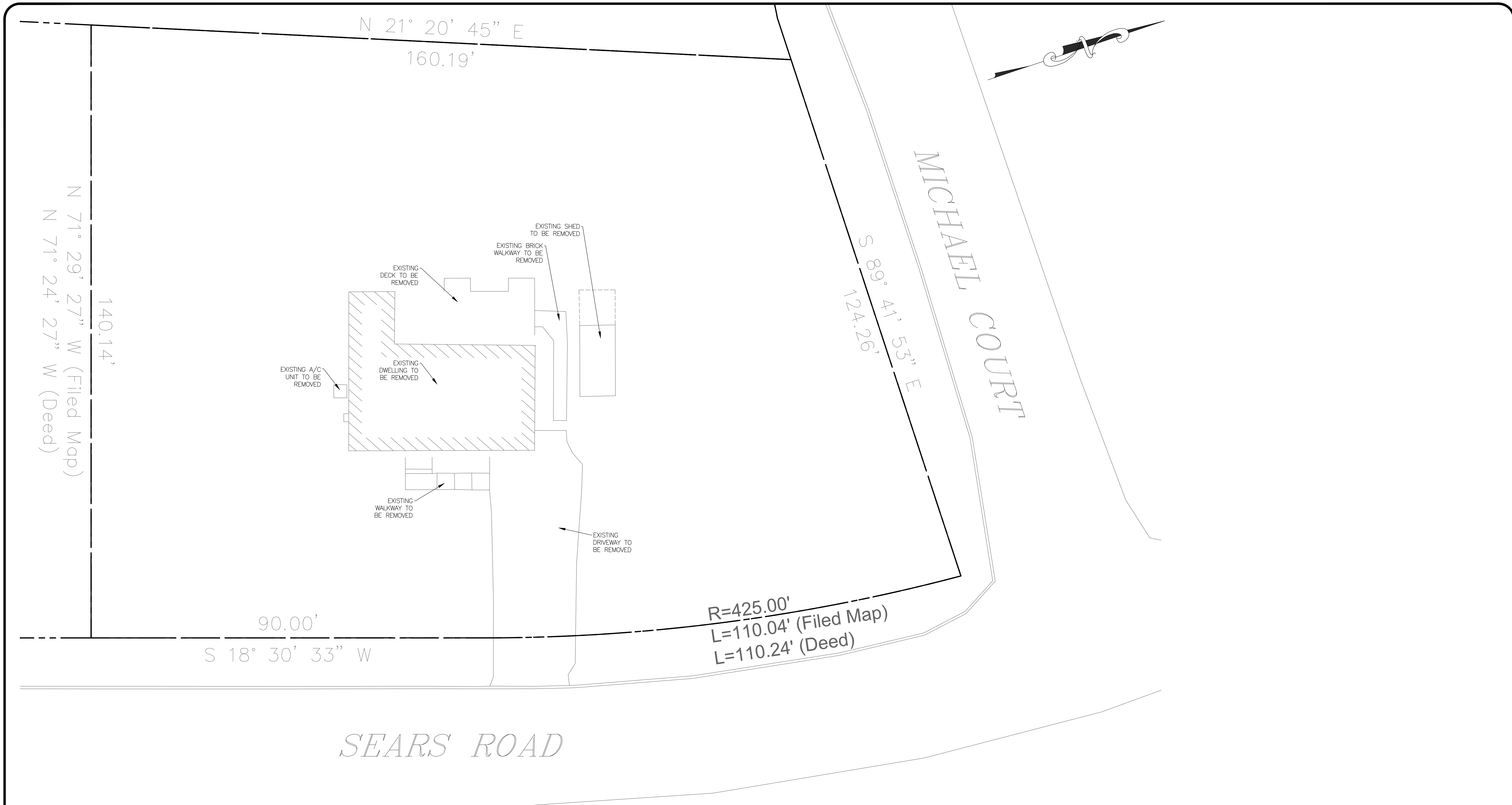

DrawME

NO.	REVISION	DATE	DR/CK

KEVIN P. MAHER, P.E., M.ASCE
 4 EDGEWOOD DRIVE
 CENTRAL VALLEY, NY 10917
 LIC. 065454
 NY 845-666-0155
 NJ 732-523-2289
 E-MAIL INFO@TERRANVC.COM
 5/28/2024
 DocuSigned by:

 KEVIN P. MAHER, P.E., M.ASCE LIC. 065454 DATE

DEMOLITION PLAN

DESIGN BY: YB	DRAWN BY: JM	CHECKED BY: KPM
------------------	-----------------	--------------------

15 SEARS
 15 SEARS RD., VILLAGE OF SOUTH BLOOMING GROVE,
 ORANGE COUNTY, NY 10950
 SBL 216-1-16

DRAWING NUMBER: 02 OF 07	SCALE: 1"=20'	FILE NO.: 24177	DATE: 05/28/2024
---	------------------	--------------------	---------------------

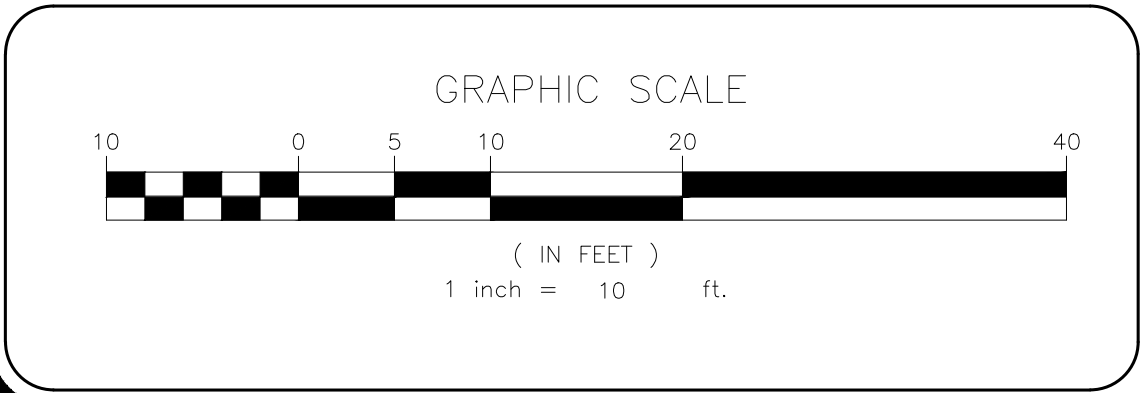
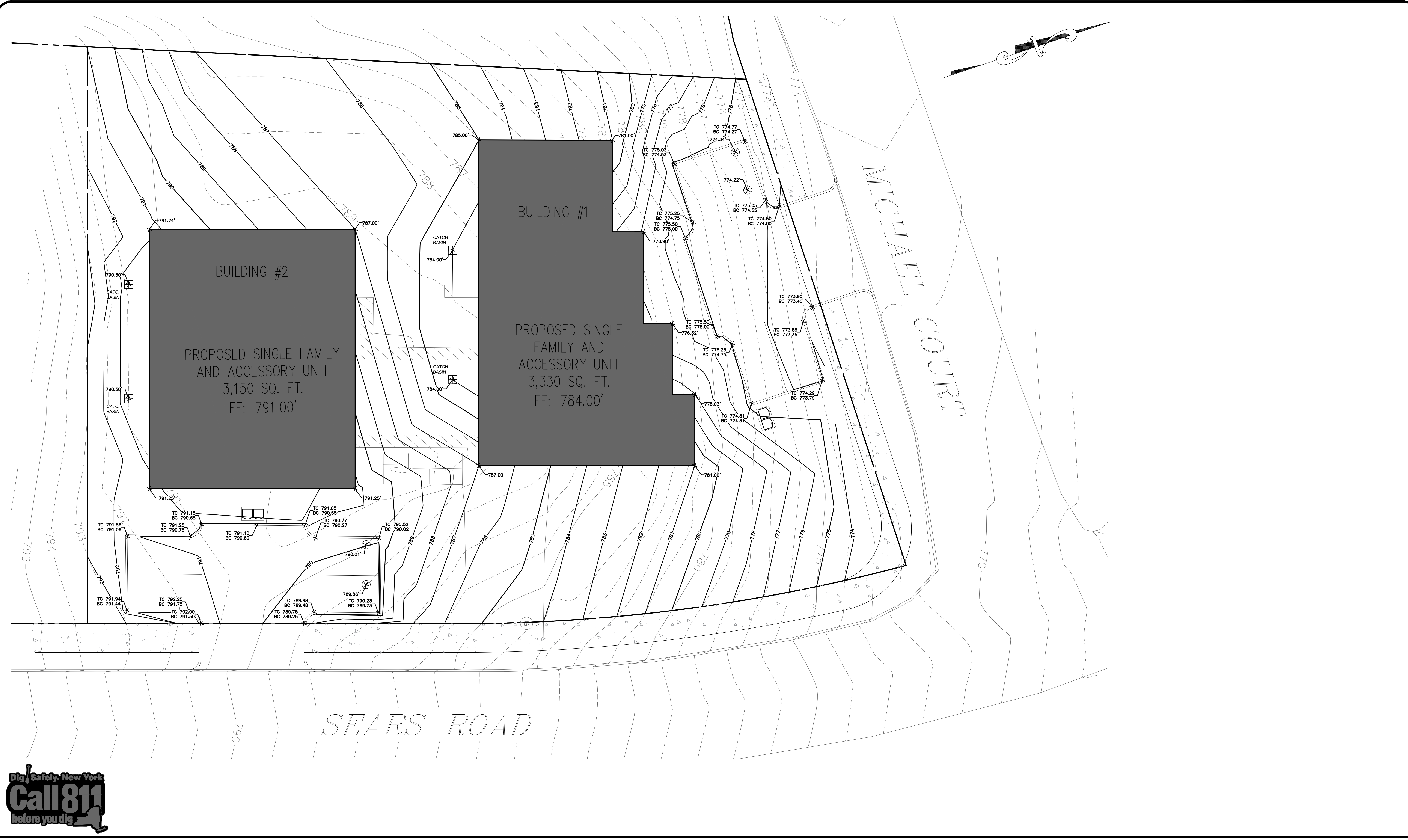

NO.	REVISION	DATE	DR/CK

KEVIN P. MAHER, P.E., M.ASCE
 4 EDGEWOOD DRIVE
 CENTRAL VALLEY, NY 10917
 LIC. 065454
 NY 845-666-0155
 NJ 732-523-2289
 E-MAIL: INFO@TERRANVC.COM
 5/28/2024

DocuSigned by:
 KEVIN P. MAHER, P.E., M.ASCE LIC. 065454 DATE

GRADING PLAN

DESIGN BY: YB	DRAWN BY: JM	CHECKED BY: KPM
------------------	-----------------	--------------------

15 SEARS

15 SEARS RD., VILLAGE OF SOUTH BLOOMING GROVE,
 ORANGE COUNTY, NY 10950
 SBL 216-1-16

DRAWING NUMBER: 03 OF 07	SCALE: 1"=20'	FILE NO.: 24177	DATE: 05/28/2024
---	------------------	--------------------	---------------------

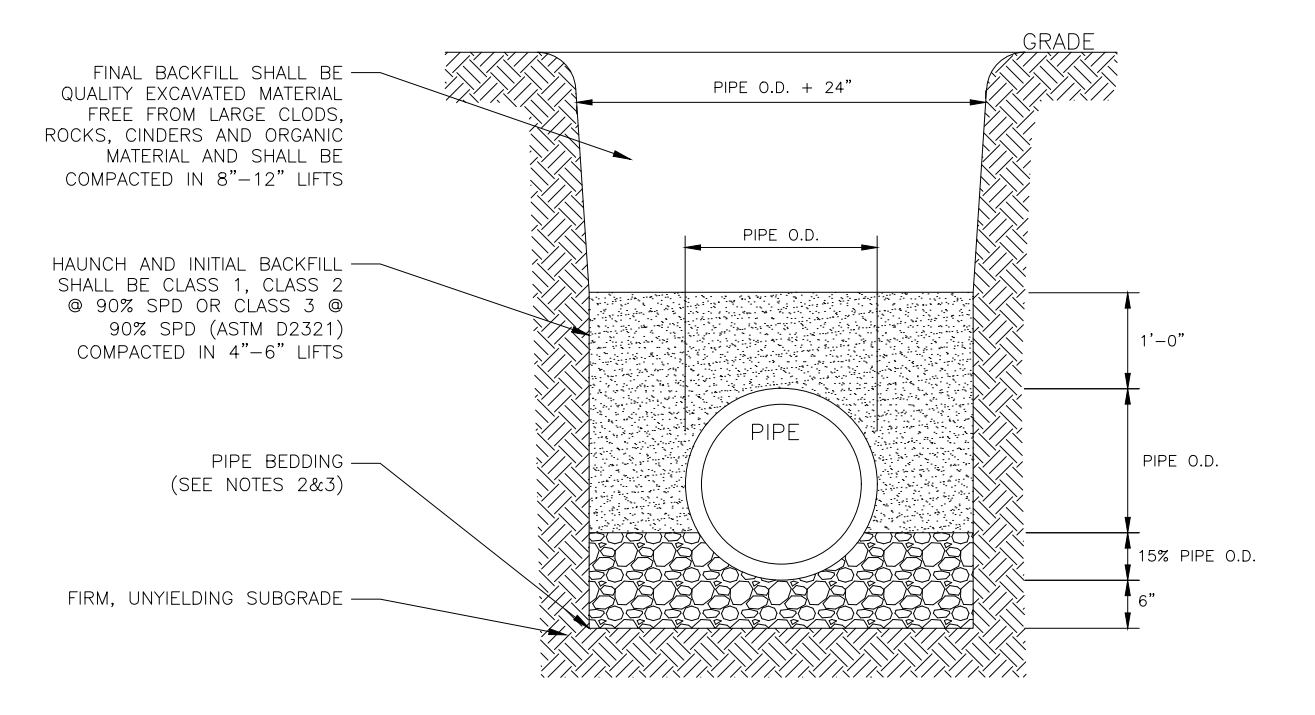
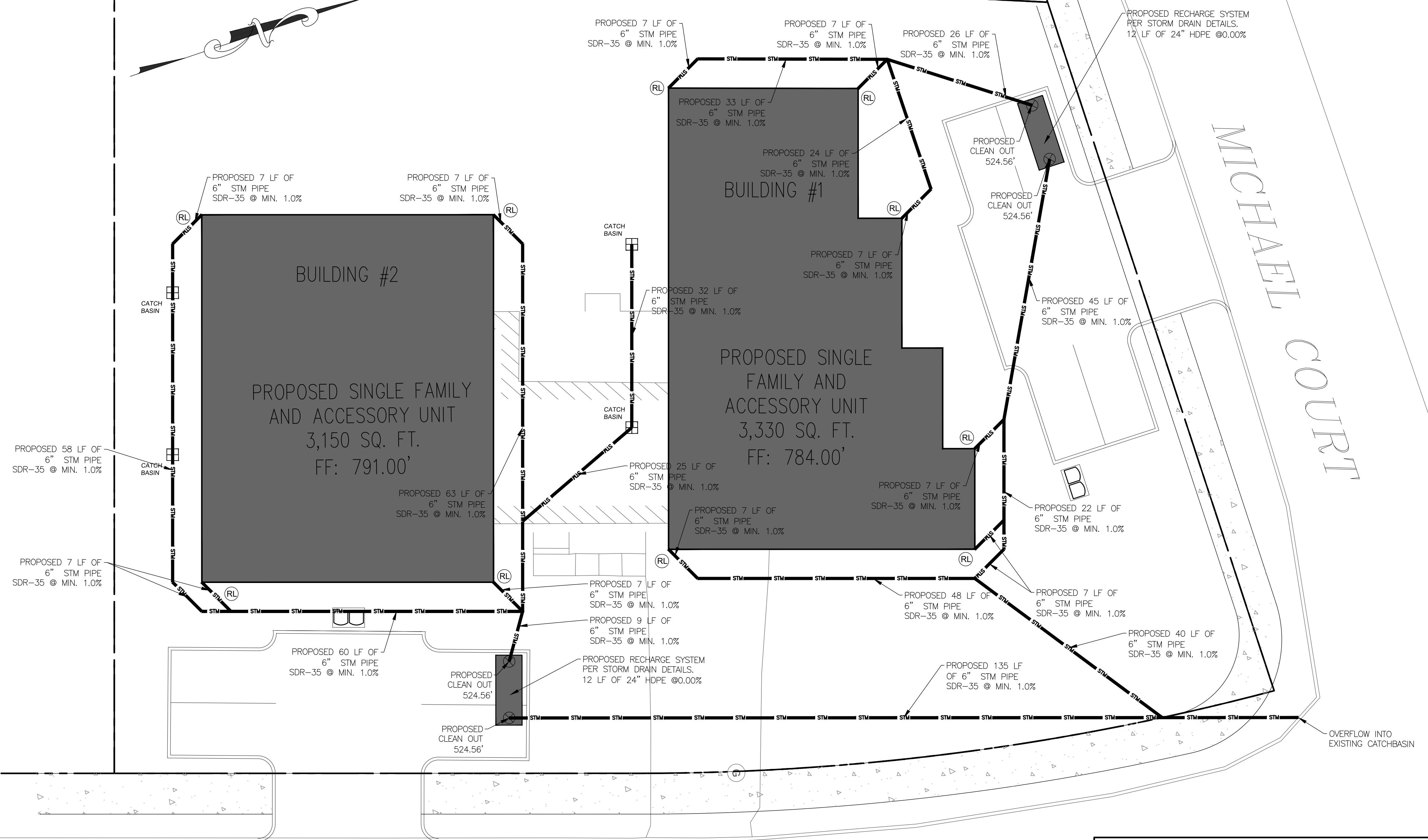
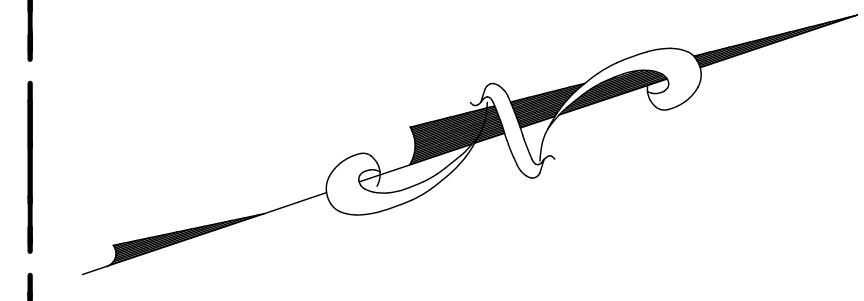

- NOTES: 1. SOIL CLASSES AS DEFINED IN ASTM D 2487 AND D 2321. 2. PIPE BEDDING FOR STORM SEWERS SHALL BE CLASS 1 EMBEDMENT MATERIAL OR CLASS 2 OR 3 EMBEDMENT MATERIAL COMPACTED TO 90% STANDARD PROCTOR DENSITY. 3. PIPE BEDDING FOR WATERMAIN SHALL BE CLASS 1 EMBEDMENT MATERIAL OR SAND. 4. PARTICLE SIZE IN THE EMBEDMENT ZONE SHALL NOT EXCEED 2". 5. WHERE UNSUITABLE MATERIAL IS ENCOUNTERED IN TRENCH BOTTOM, UNDERCUT TO SUITABLE MATERIAL. 6. PIPE BEDDING AND BACKFILL IS TO BE IN ACCORDANCE WITH PIPE MANUFACTURER'S INSTALLATION GUIDES AND REQUIREMENTS.

DR#2 N.T.S. 03/24 PIPE BEDDING & BACKFILL DETAIL

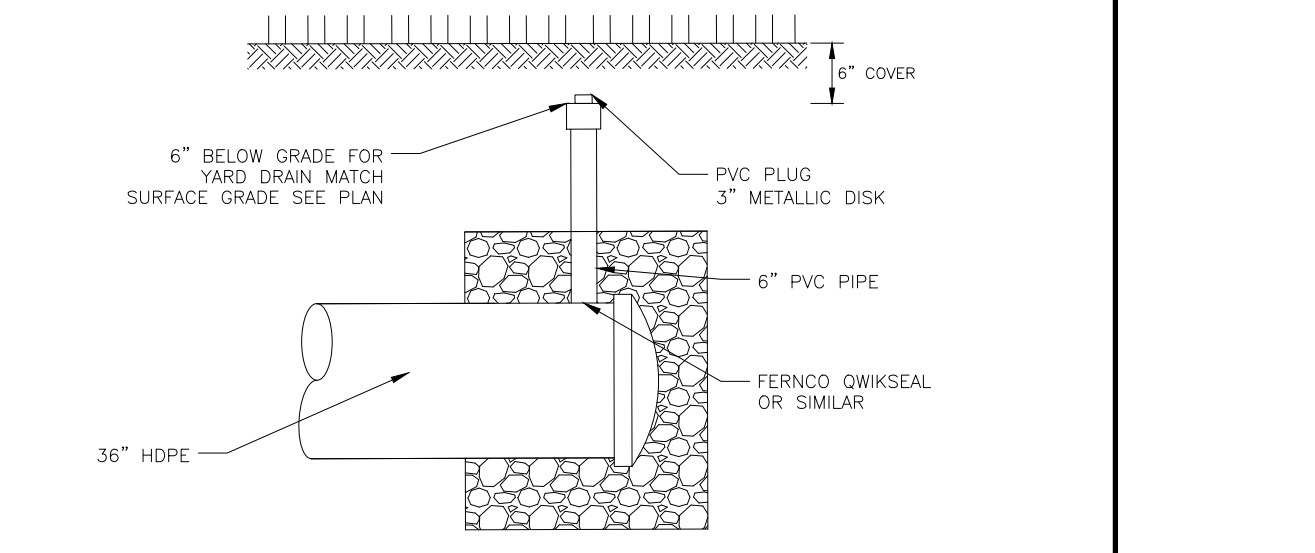

- NOTES: 1. CLEANOUT TO BE PROVIDED ON BOTH ENDS OF TRENCH. 2. ROOF DRAIN TO BE CONNECTED TO PIPE WITH PREMANUFACTURED FITTING OR NEATLY SAW OUT WITHIN THE LIMITS OF THE STONE BEDDING.

CD#5 N.T.S. 03/24 CLEANOUT DETAIL

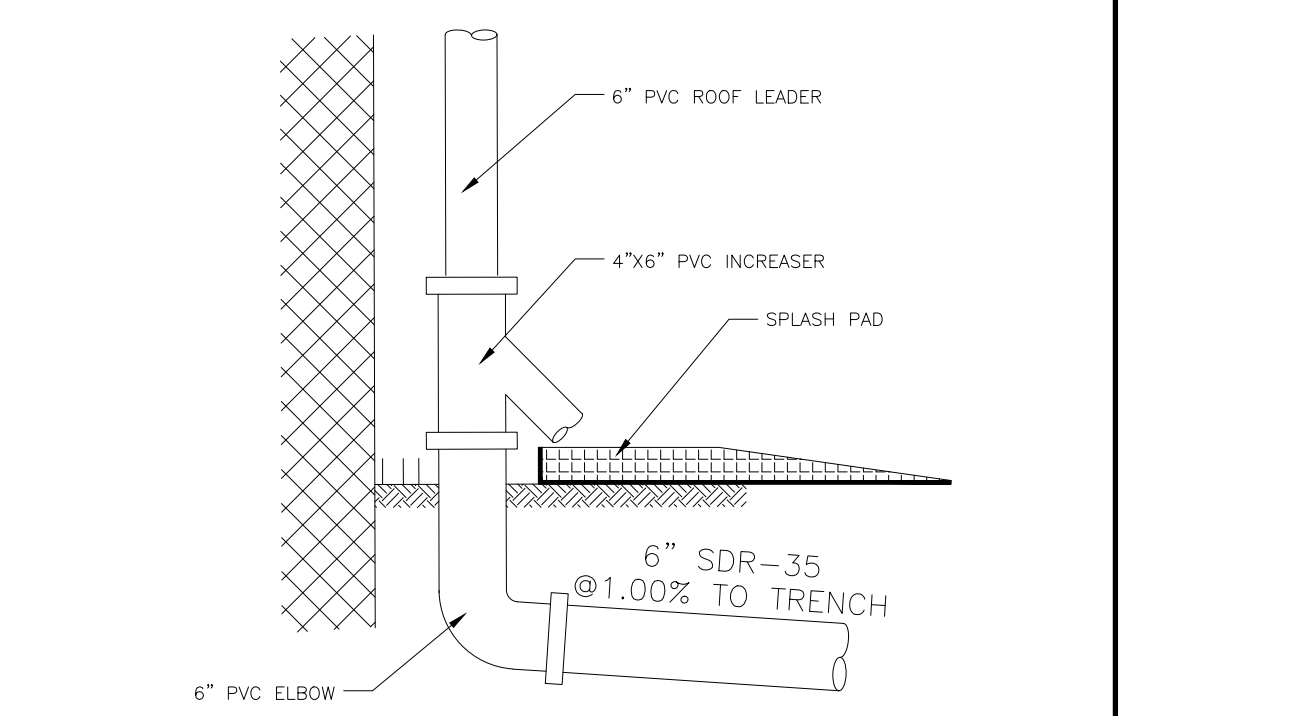

CD#6 N.T.S. 03/24 ROOF LEADER DETAIL

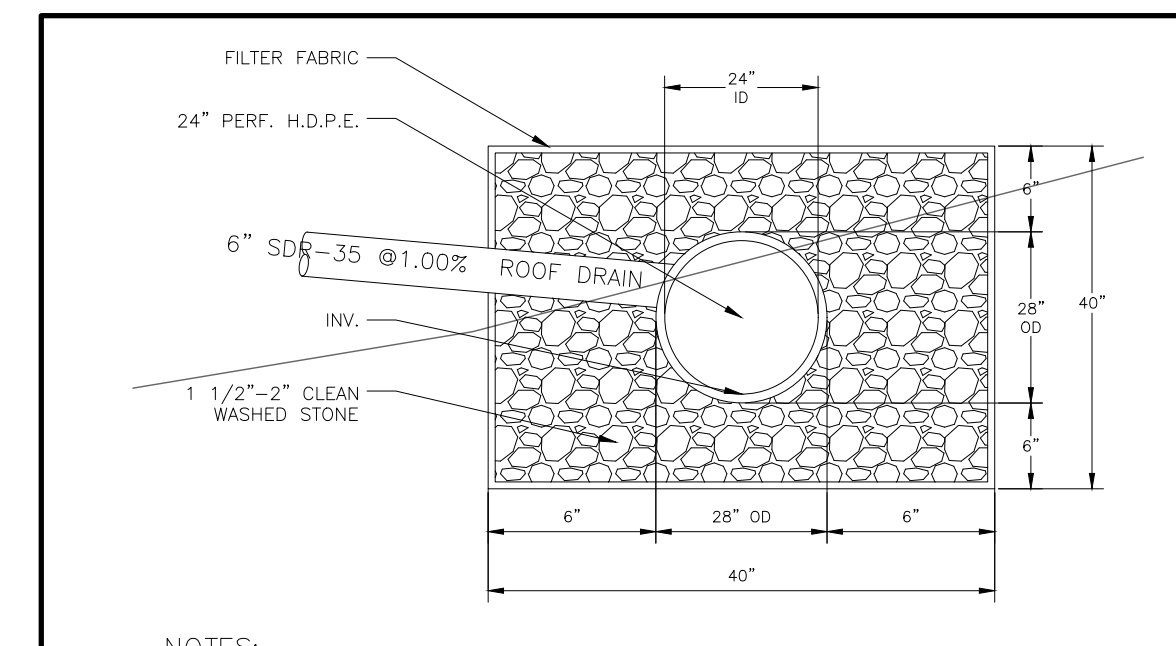

- NOTES: 1. FILTER FABRIC TO BE MIRAFI 140A OR EQUAL. 2. STONE TO HAVE A MINIMUM VOID RATIO OF 0.40.

DR#1 N.T.S. 05/24 RECHARGE TRENCH DETAIL

LEGEND:

RL PROPOSED 6" PVC ROOF LEADER PER STORM DRAIN DETAILS.



RECHARGE NOTES:

- 1. RECHARGE TRENCHES ARE TO BE LOCATED A MINIMUM OF 8 FEET FROM THE FOUNDATION WITH AN INVERT 1 FOOT LOWER THAN THE BASEMENT FLOOR. 2. THE SYSTEM COLLECTS AND RECHARGES THE CLEAN RUNOFF FROM THE ROOF. IN THE EVENT THAT THE SYSTEM FAILS AND NO LONGER RECHARGES WATER, THE SYSTEM WILL OVERFLOW OUT OF THE WYE FITTING IN THE ROOF LEADER. RUNOFF WILL THEN FLOW ACROSS THE LAWN AREA WHICH IS STABILIZED WITH GRASS OR OTHER GROUND COVER. THERE SHOULD BE NO CATASTROPHIC FAILURE THAT WOULD CAUSE DAMAGING EROSION DURING NORMAL STORM EVENTS.

RUNOFF CALCULATIONS BUILDING #1:

3,330.00 SF (PROPOSED COVERAGE) 0.50 INCH/ 2 HOUR STORM 3,330.00 SF X 0.50 IN X 1 FT/12 INCHES = 138.75 CF REQUIRED RECHARGE TRENCH VOL = 12.34 CF/LF 138.75/12.34 = 11.25 LF REQUIRED 12 LF OF TRENCH PROPOSED X 12.34 CF/LF = 148.08 CF PROVIDED

RUNOFF CALCULATIONS BUILDING #2:

3,150.00 SF (PROPOSED COVERAGE) 0.50 INCH/ 2 HOUR STORM 3,150.00 SF X 0.50 IN X 1 FT/12 INCHES = 131.25 CF REQUIRED RECHARGE TRENCH VOL = 12.34 CF/LF 131.25/12.34 = 10.64 LF REQUIRED 12 LF OF TRENCH PROPOSED X 12.34 CF/LF = 148.08 CF PROVIDED

SEARS ROAD

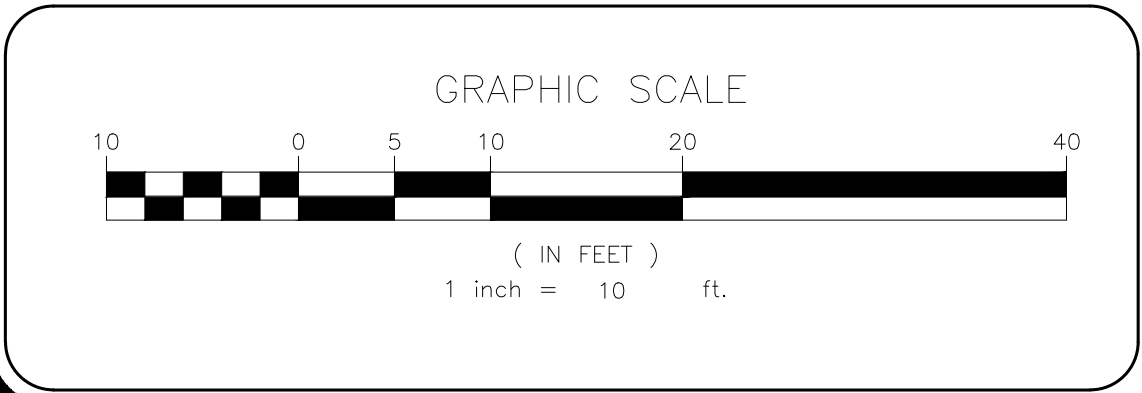

NO.	REVISION	DATE	DR/CK

KEVIN P. MAHER, P.E., M.ASCE 4 EDGEWOOD DRIVE CENTRAL VALLEY, NY 10917 LIC. 065454 NY 845-666-0155 NJ 732-523-2289 E-MAIL INFO@TERRANVC.COM 5/28/2024

DRAINAGE PLAN DESIGN BY: YB DRAWN BY: JM CHECKED BY: KPM

15 SEARS 15 SEARS RD., VILLAGE OF SOUTH BLOOMING GROVE, ORANGE COUNTY, NY 10950 SBL 216-1-16 DRAWING NUMBER: 04 OF 07 SCALE: 1"=20' FILE NO.: 24177 DATE: 05/28/2024

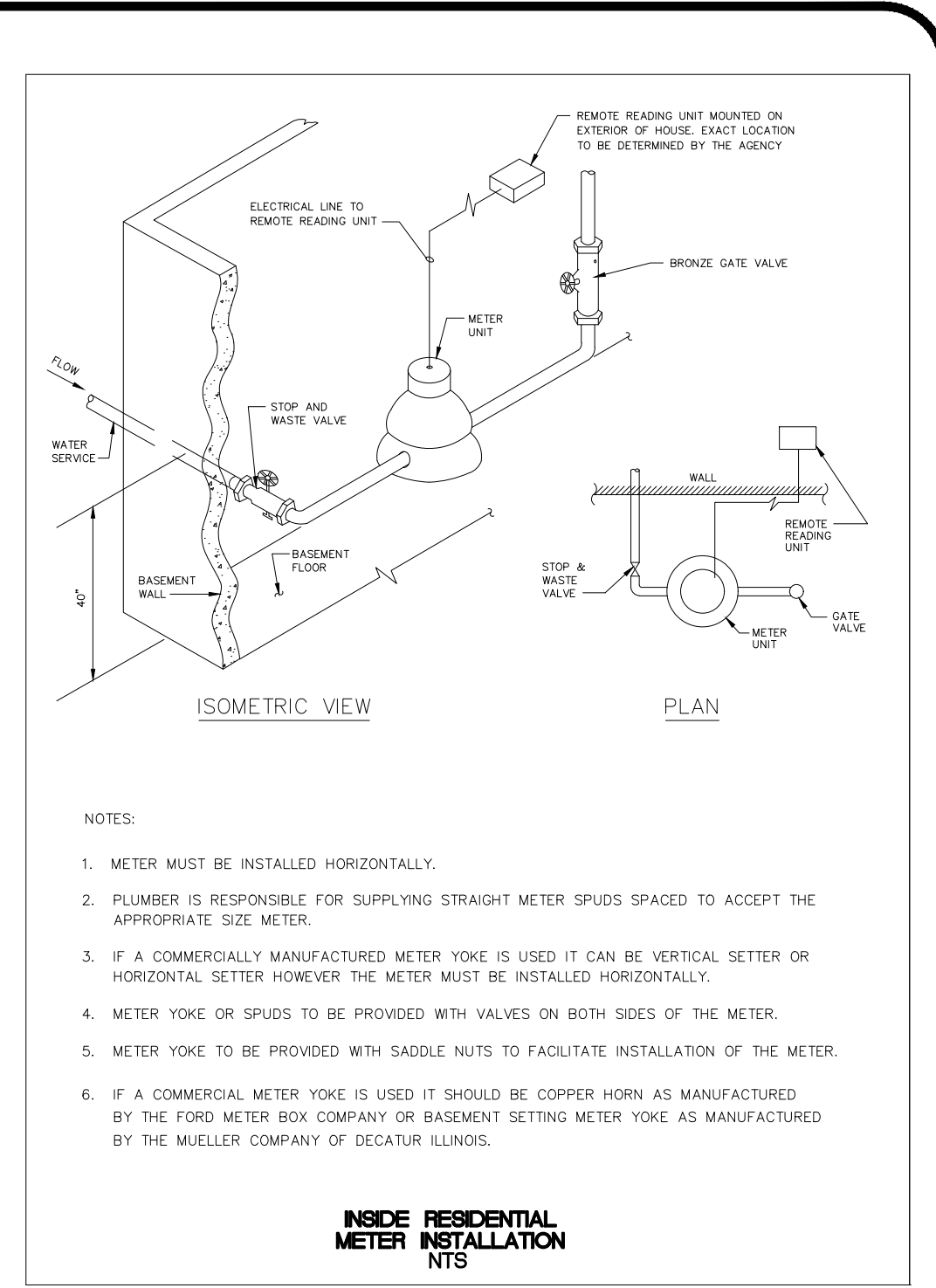
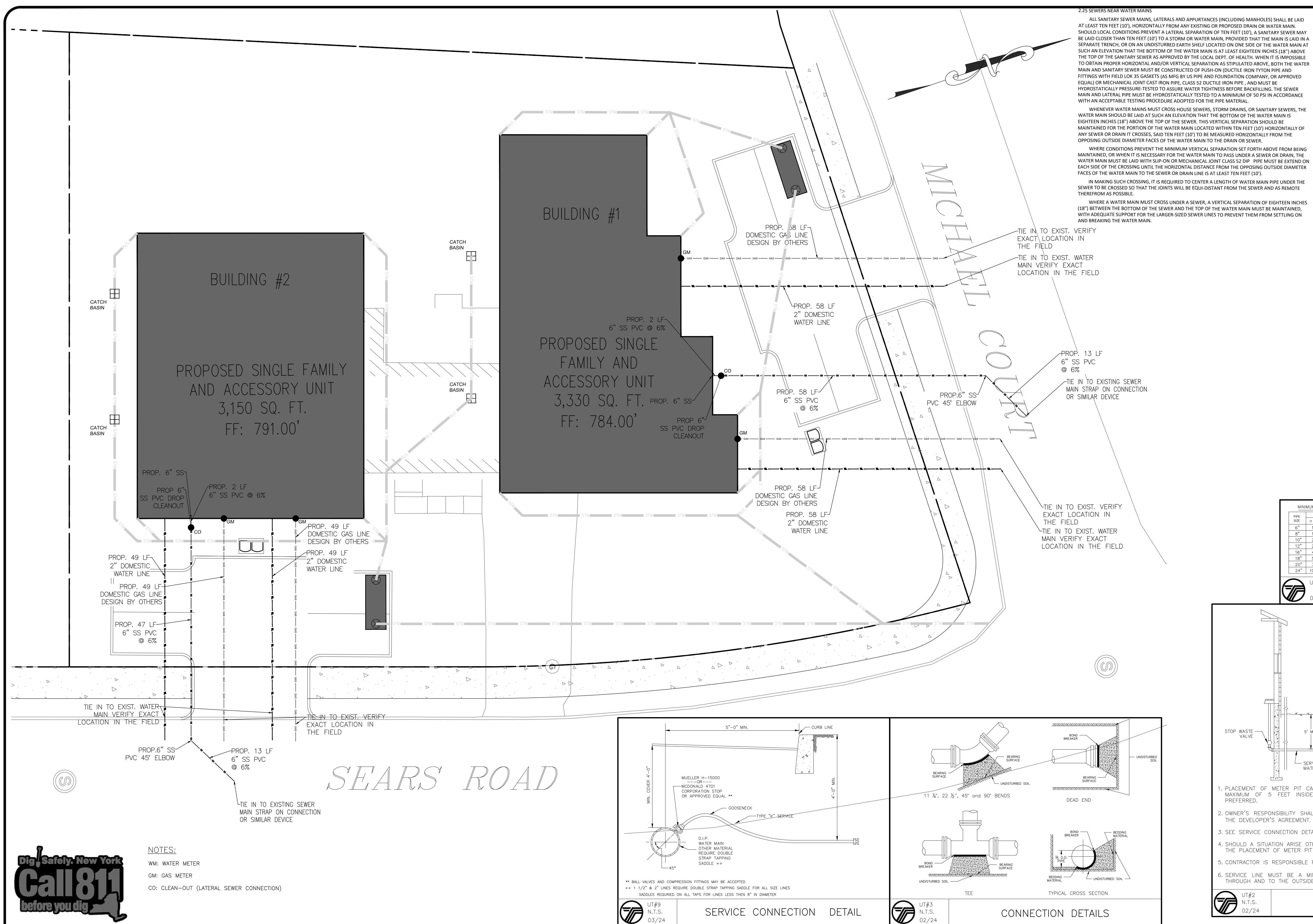

- NOTES:
- METER MUST BE INSTALLED HORIZONTALLY.
 - PLUMBER IS RESPONSIBLE FOR SUPPLYING STRAIGHT METER SPUDS SPACED TO ACCEPT THE APPROPRIATE SIZE METER.
 - IF A COMMERCIAL MANUFACTURED METER YOKES IS USED IT CAN BE VERTICAL SETTER OR HORIZONTAL SETTER HOWEVER THE METER MUST BE INSTALLED HORIZONTALLY.
 - METER YOKES OR SPUDS TO BE PROVIDED WITH VALVES ON BOTH SIDES OF THE METER.
 - METER YOKES TO BE PROVIDED WITH SADDLE NUTS TO FACILITATE INSTALLATION OF THE METER.
 - IF A COMMERCIAL METER YOKES IS USED IT SHOULD BE COPPER HORN AS MANUFACTURED BY THE FORD METER BOX COMPANY OR BASEMENT SETTING METER YOKES AS MANUFACTURED BY THE MUELLER COMPANY OF DECATUR ILLINOIS.

2.25 SEWERS NEAR WATER MAINS
ALL SANITARY SEWER MAINS, LATERALS AND APPURTANCES (INCLUDING MANHOLES) SHALL BE LAID AT LEAST TEN FEET (10'), HORIZONTALLY FROM ANY EXISTING OR PROPOSED DRAIN OR WATER MAIN. SHOULD LOCAL CONDITIONS PREVENT A LATERAL SEPARATION OF TEN FEET (10'), A SANITARY SEWER MAY BE LAID CLOSER THAN TEN FEET (10') TO A STORM OR WATER MAIN, PROVIDED THAT THE MAIN IS LAID IN A SEPARATE TRENCH, OR ON AN UNDISTURBED EARTH SHELF LOCATED ON ONE SIDE OF THE WATER MAIN AT SUCH AN ELEVATION THAT THE BOTTOM OF THE WATER MAIN IS AT LEAST EIGHTEEN INCHES (18") ABOVE THE TOP OF THE SANITARY SEWER AS APPROVED BY THE LOCAL DEPT. OF HEALTH. WHEN IT IS IMPOSSIBLE TO OBTAIN PROPER HORIZONTAL AND/OR VERTICAL SEPARATION AS STIPULATED ABOVE, BOTH THE WATER MAIN AND SANITARY SEWER MUST BE CONSTRUCTED OF PUSH-ON (DUCTILE IRON TYTON PIPE AND FITTINGS WITH FIELD DUK 35 GASKETS AS MFG BY US PIPE AND FOUNDATION COMPANY, OR APPROVED EQUAL) OR MECHANICAL JOINT CAST IRON PIPE, CLASS 52 DUCTILE IRON PIPE, AND MUST BE HYDROSTATICALLY PRESSURE-TESTED TO ASSURE WATER TIGHTNESS BEFORE BACKFILLING. THE SEWER MAIN AND LATERAL PIPE MUST BE HYDROSTATICALLY TESTED TO A MINIMUM OF 50 PSI IN ACCORDANCE WITH AN ACCEPTABLE TESTING PROCEDURE ADOPTED FOR THE PIPE MATERIAL.

WHENEVER WATER MAINS MUST CROSS HOUSE SEWERS, STORM DRAINS, OR SANITARY SEWERS, THE WATER MAIN SHOULD BE LAID AT SUCH AN ELEVATION THAT THE BOTTOM OF THE WATER MAIN IS EIGHTEEN INCHES (18") ABOVE THE TOP OF THE SEWER. THIS VERTICAL SEPARATION SHOULD BE MAINTAINED FOR THE PORTION OF THE WATER MAIN LOCATED WITHIN TEN FEET (10') HORIZONTALLY OF ANY SEWER OR DRAIN IT CROSSES. SAID TEN FEET (10') TO BE MEASURED HORIZONTALLY FROM THE OPPOSING OUTSIDE DIAMETER FACES OF THE WATER MAIN TO THE DRAIN OR SEWER.

WHERE CONDITIONS PREVENT THE MINIMUM VERTICAL SEPARATION SET FORTH ABOVE FROM BEING MAINTAINED, OR WHEN IT IS NECESSARY FOR THE WATER MAIN TO PASS UNDER A SEWER OR DRAIN, THE WATER MAIN MUST BE LAID WITH SLOPE-ON OR MECHANICAL JOINT CLASS 52 DIP. PIPE MUST BE EXTEND ON EACH SIDE OF THE CROSSING UNTIL THE HORIZONTAL DISTANCE FROM THE OPPOSING OUTSIDE DIAMETER FACES OF THE WATER MAIN TO THE SEWER OR DRAIN LINE IS AT LEAST TEN FEET (10').

IN MAKING SUCH CROSSING, IT IS REQUIRED TO CENTER A LENGTH OF WATER MAIN PIPE UNDER THE SEWER TO BE CROSSED SO THAT THE JOINTS WILL BE EQUI-DISTANT FROM THE SEWER AND AS REMOTE THEREFROM AS POSSIBLE.

WHERE A WATER MAIN MUST CROSS UNDER A SEWER, A VERTICAL SEPARATION OF EIGHTEEN INCHES (18") BETWEEN THE BOTTOM OF THE SEWER AND THE TOP OF THE WATER MAIN MUST BE MAINTAINED, WITH ADEQUATE SUPPORT FOR THE LARGER-SIZED SEWER LINES TO PREVENT THEM FROM SETTLING ON AND BREAKING THE WATER MAIN.

PIPE SIZE	MINIMUM BEARING SURFACE AREA (FT ²)				
	B	E	N	D	S
6"	1.0	1.5	2.5	4.5	3.5
8"	1.0	2.5	4.5	8.0	5.5
10"	2.0	3.5	7.0	12.5	9.0
12"	2.5	5.0	9.5	17.5	12.5
16"	4.5	8.5	17.0	31.0	22.5
18"	5.5	11.0	21.5	39.5	28.5
20"	7.0	13.5	27.0	49.0	35.0
24"	10.0	19.5	38.5	70.5	50.0

NOTES:
1. ON 16" AND LARGER TRANSMISSION MAINS BENDS SHALL BE 90° RADIUS AND THRUST BLOCKED.
2. BEARING SURFACES SHOWN IN CHART ARE MINIMUM.
3. BASED ON 150 PSI INTERNAL PIPE PRESSURE PLUS WATER HAMMER = 150PSI.
4. 12" WATER HAMMER = 110 PSI.
5. 16" AND LARGER WATER HAMMER = 70 PSI.
6. SOIL BEARING CAPACITY = 3,000 LB./SQ. FT.
7. ALL 90 DEGREE BENDS SHALL BE RADIUS AND THRUST BLOCKED.
8. NA = NOT APPLICABLE.

UT#11
03/24 CONCRETE THRUST BLOCK DETAIL

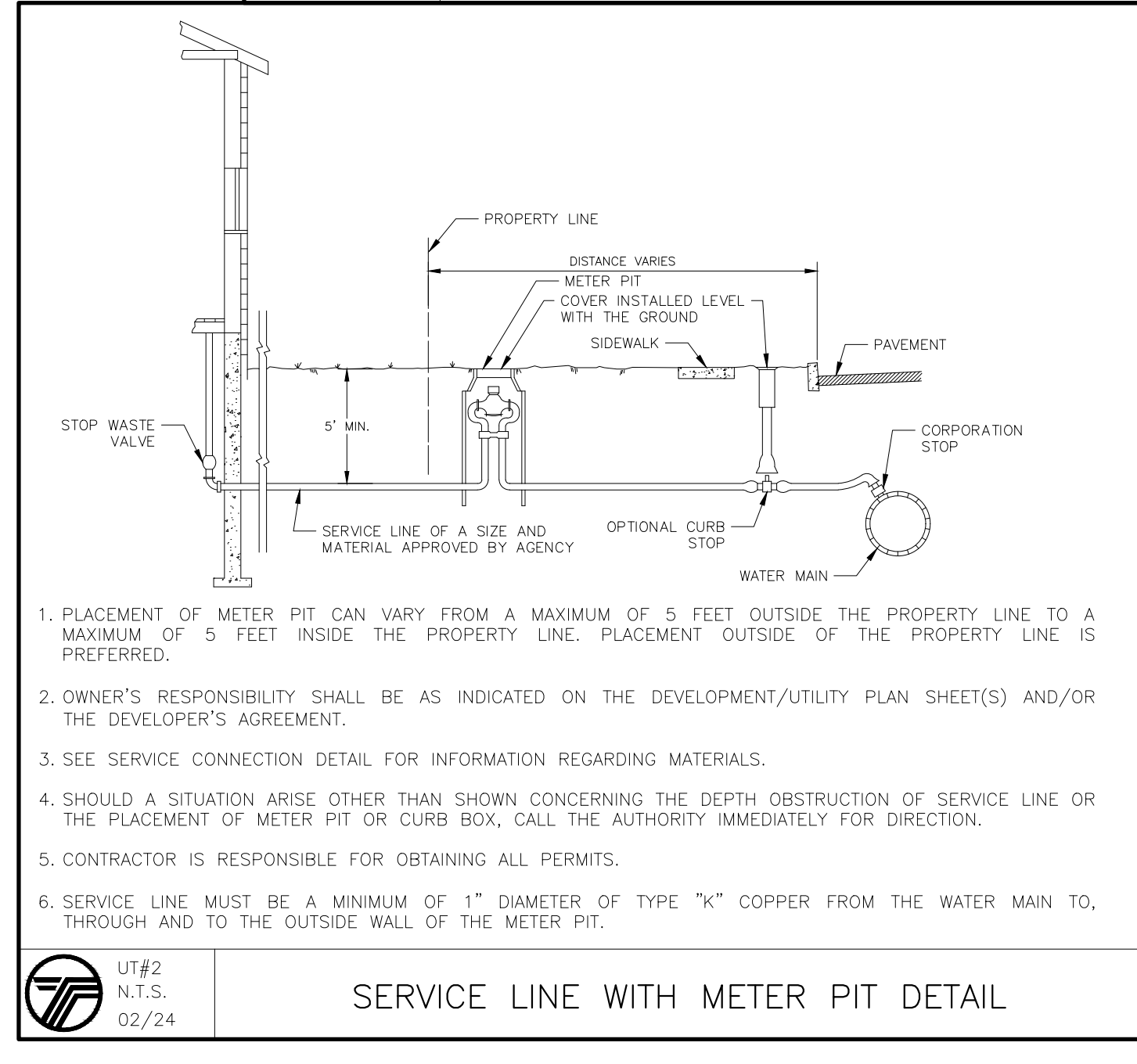

- PLACEMENT OF METER PIT CAN VARY FROM A MAXIMUM OF 5 FEET OUTSIDE THE PROPERTY LINE TO A MAXIMUM OF 5 FEET INSIDE THE PROPERTY LINE. PLACEMENT OUTSIDE OF THE PROPERTY LINE IS PREFERRED.
- OWNER'S RESPONSIBILITY SHALL BE AS INDICATED ON THE DEVELOPMENT/UTILITY PLAN SHEET(S) AND/OR THE DEVELOPER'S AGREEMENT.
- SEE SERVICE CONNECTION DETAIL FOR INFORMATION REGARDING MATERIALS.
- SHOULD A SITUATION ARISE OTHER THAN SHOWN CONCERNING THE DEPTH OBSTRUCTION OF SERVICE LINE OR THE PLACEMENT OF METER PIT OR CURB BOX, CALL THE AUTHORITY IMMEDIATELY FOR DIRECTION.
- CONTRACTOR IS RESPONSIBLE FOR OBTAINING ALL PERMITS.
- SERVICE LINE MUST BE A MINIMUM OF 1" DIAMETER OF TYPE "K" COPPER FROM THE WATER MAIN TO, THROUGH AND TO THE OUTSIDE WALL OF THE METER PIT.

UT#2
N.T.S. 02/24 SERVICE LINE WITH METER PIT DETAIL

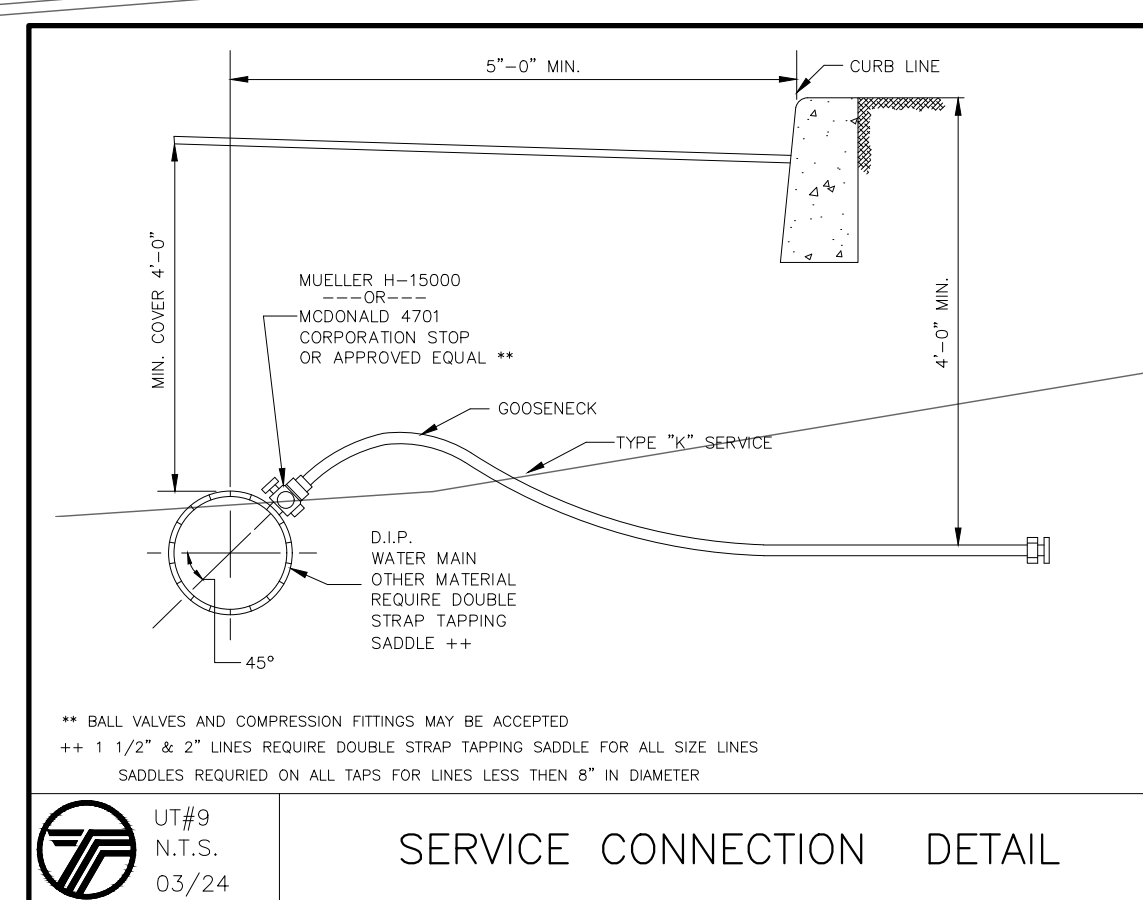

UT#9
N.T.S. 03/24 SERVICE CONNECTION DETAIL

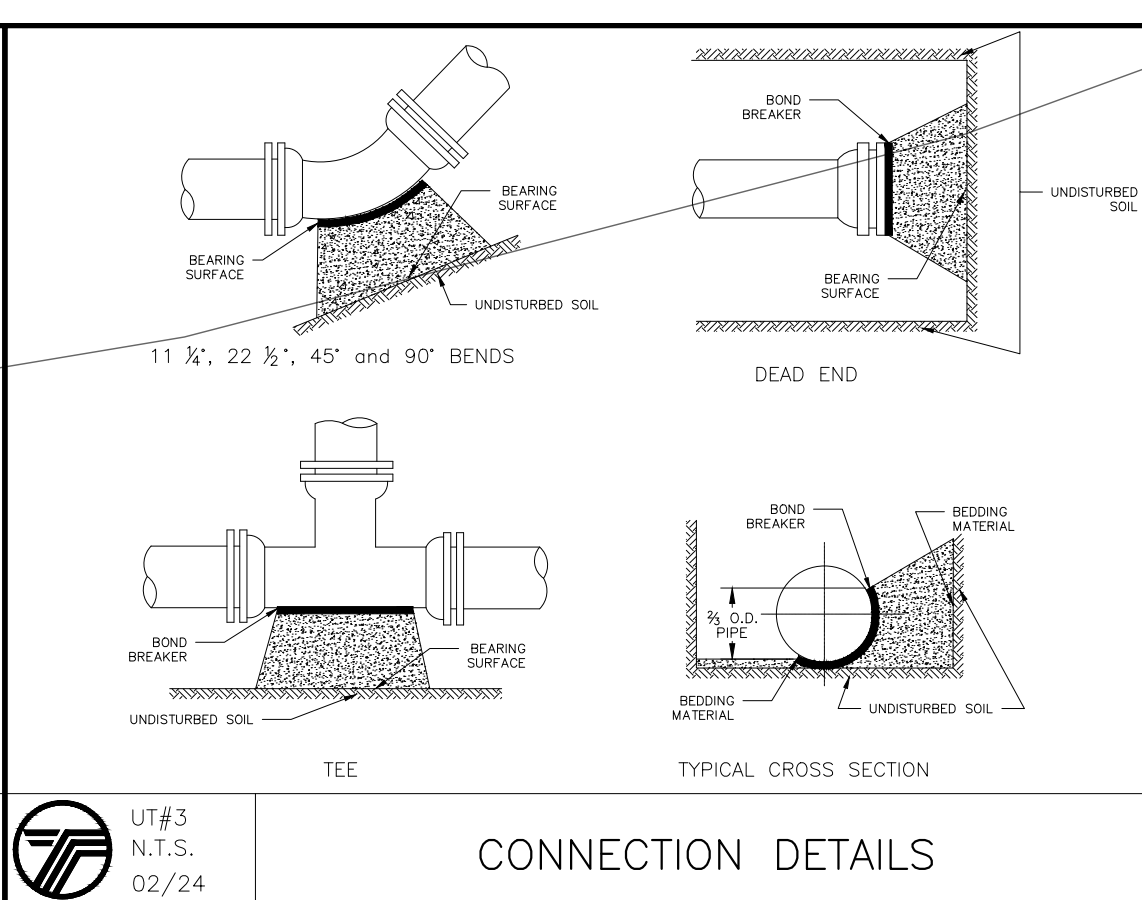

UT#3
N.T.S. 02/24 CONNECTION DETAILS

- NOTES:
- WM: WATER METER
 - GM: GAS METER
 - CO: CLEAN-OUT (LATERAL SEWER CONNECTION)

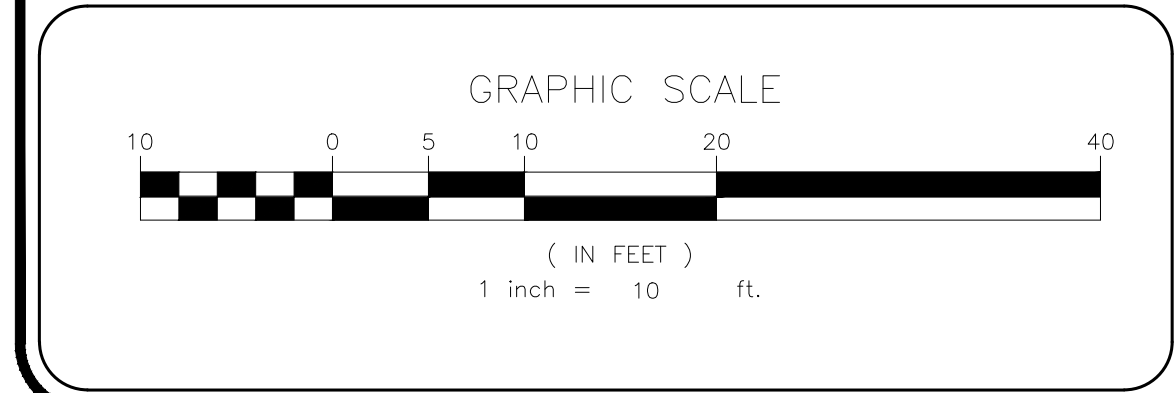

NO.	REVISION	DATE	DR/CK

KEVIN P. MAHER, P.E., M.ASCE
 4 EDGEWOOD DRIVE
 CENTRAL VALLEY, NY 10917
 LIC. 065454
 NY 845-666-0155
 NJ 732-523-2289
 E-MAIL INFO@TERRANVC.COM
 5/28/2024

DocuSigned by:

 KEVIN P. MAHER, P.E., M.ASCE LIC. 065454 DATE

UTILITY PLAN

DESIGN BY: YB
 DRAWN BY: JM
 CHECKED BY: KPM

15 SEARS
 15 SEARS RD., VILLAGE OF SOUTH BLOOMING GROVE,
 ORANGE COUNTY, NY 10950
 SBL 216-1-16

DRAWING NUMBER: **05** OF **07**
 SCALE: 1"=20'
 FILE NO.: 24177
 DATE: 05/28/2024

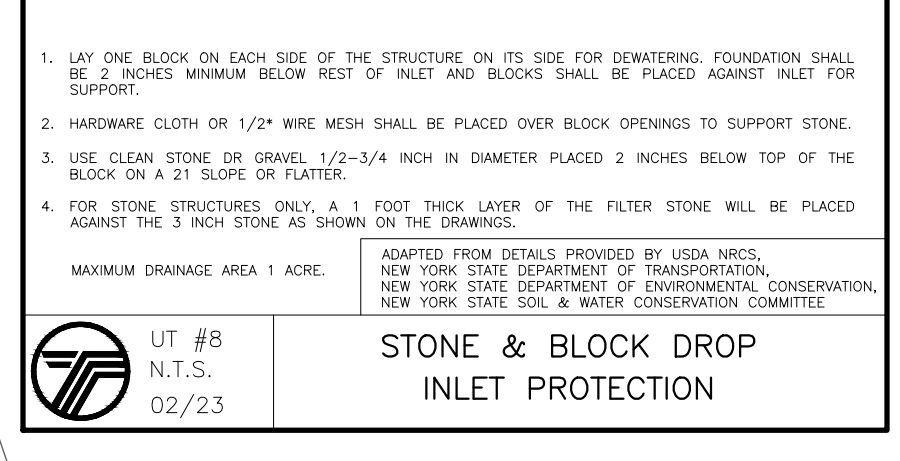
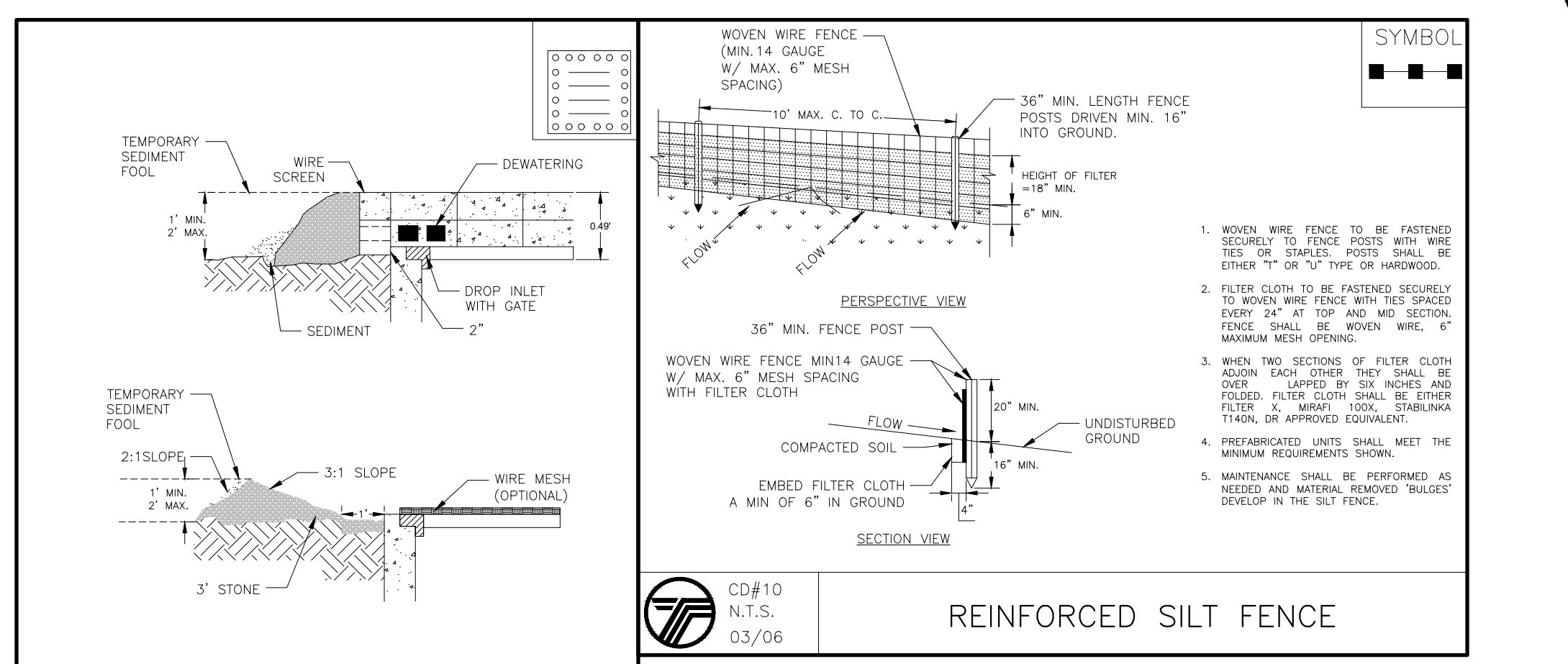
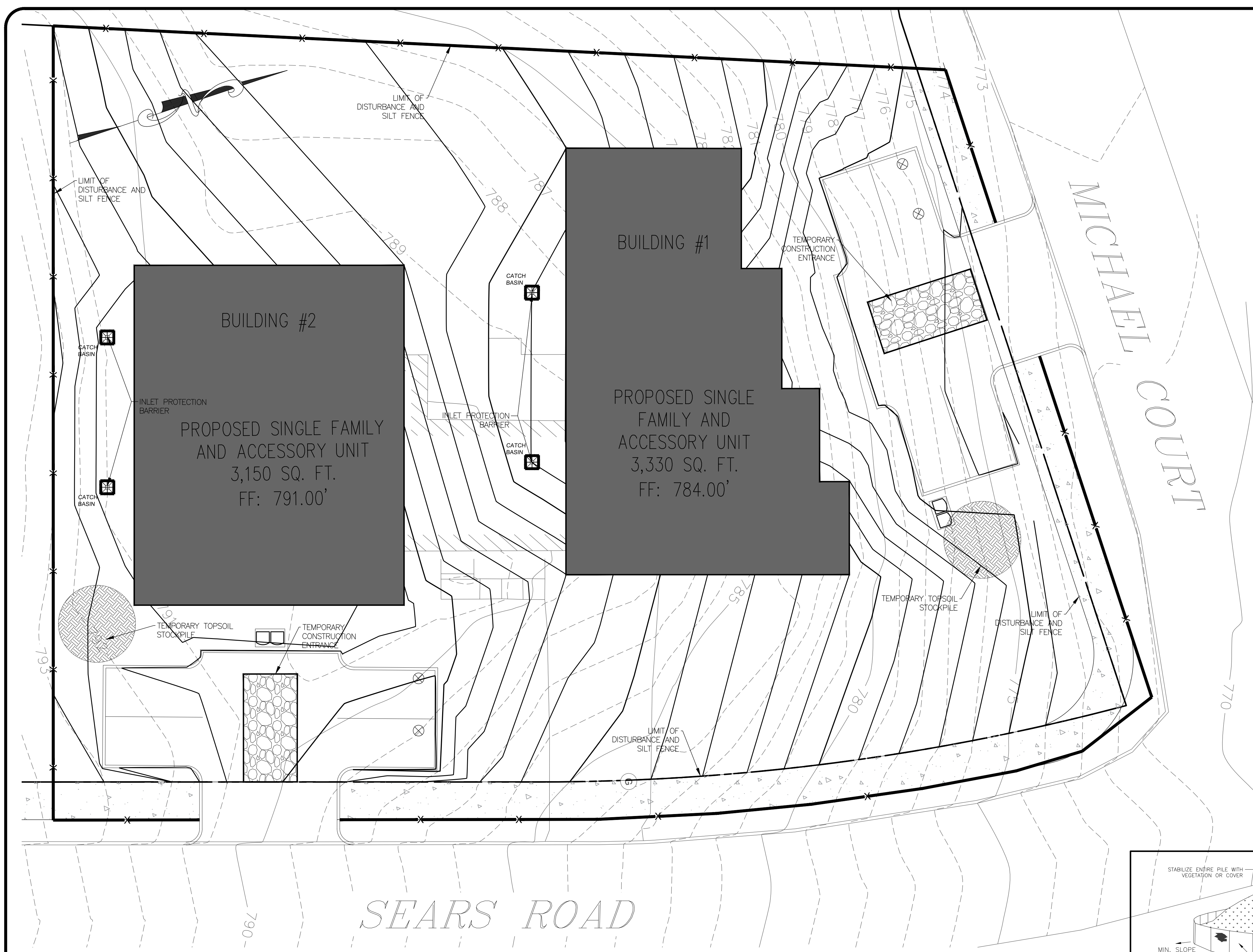

- SEQUENCE OF CONSTRUCTION NOTES**
- CONTRACTOR SHALL IMPLEMENT INLET PROTECTION DEVICES AND REINFORCED FILTER FABRIC BARRIER ALONG ROAD AND SIDE DITCHES AT LOCATION SHOWN ON THE TYPICAL STORM WATER POLLUTION PREVENTION (SWPPP) PLANS TO KEEP SILT AND /OR EXCAVATED MATERIALS FROM ENTERING INTO THE STORM WATER INLETS AND DITCHES EVENTUALLY POLLUTATING THE RECEIVING STORM.
 - DURING THE EXCAVATION PHASE OF THE PROJECT, CONTRACTOR SHALL SCHEDULE THE WORK IN SHORT SEGMENTS SO THAT EXCAVATED MATERIAL CAN BE QUICKLY HAULED AWAY FROM THE SITE AND TO PREVENT IT FROM STAYING UNCOLLECTED ON THE EXISTING PAVEMENT. ANY LOOSE EXCAVATED MATERIAL WHICH FALLS ON PAVEMENTS OR DRIVEWAYS SHALL BE SWEEPED BACK INTO THE EXCAVATED AREA.
 - CONTRACTOR SHALL CLEAN UP THE EXISTING STREET INTERSECTIONS AND DRIVEWAYS DAILY, AS NECESSARY, TO REMOVE ANY EXCESS MUD, SILT OR ROCK TRACKED FROM THE EXCAVATED AREA.
 - CONTRACTOR SHALL FOLLOW GOOD HOUSEKEEPING PRACTICES DURING THE CONSTRUCTION OF THE PROJECT ALWAYS CLEANING UP DIRT AND LOOSE MATERIAL AS CONSTRUCTION PROGRESSES.
 - CONTRACTOR TO INSPECT AND MAINTAIN THE AREAS LISTED BELOW AT LEAST ONCE EVERY FOURTEEN (14) CALENDAR DAYS AND WITHIN 24 HOURS OF THE END OF A STORM EVENT OF 0.5 INCHES OR GREATER.
 - DISTURBED AREAS OF THE CONSTRUCTION SITE THAT HAVE NOT BEEN FINALLY STABILIZED.
 - AREAS USED FOR STORAGE OF MATERIALS THAT ARE EXPOSED TO PRECIPITATION.
 - STRUCTURAL CONTROL MEASURES.
 - LOCATIONS WHERE VEHICLES ENTER OR EXIT THE SITE.
 - CONTRACTOR TO BE RESPONSIBLE TO MAINTAIN EXISTING DITCHES AND/ OR CULVERTS FOR UNOBSTRUCTED DRAINAGE AT ALL TIMES. WHERE SODDING IS DISTURBED BY EXCAVATION ON BACKFILLING OPERATIONS, SUCH AREAS SHALL BE REPLACED BY SEEDING OR SODDING. SLOPES 4:1 OR STEPPER SHALL BE REPLACED BY CLOCK SODDING.

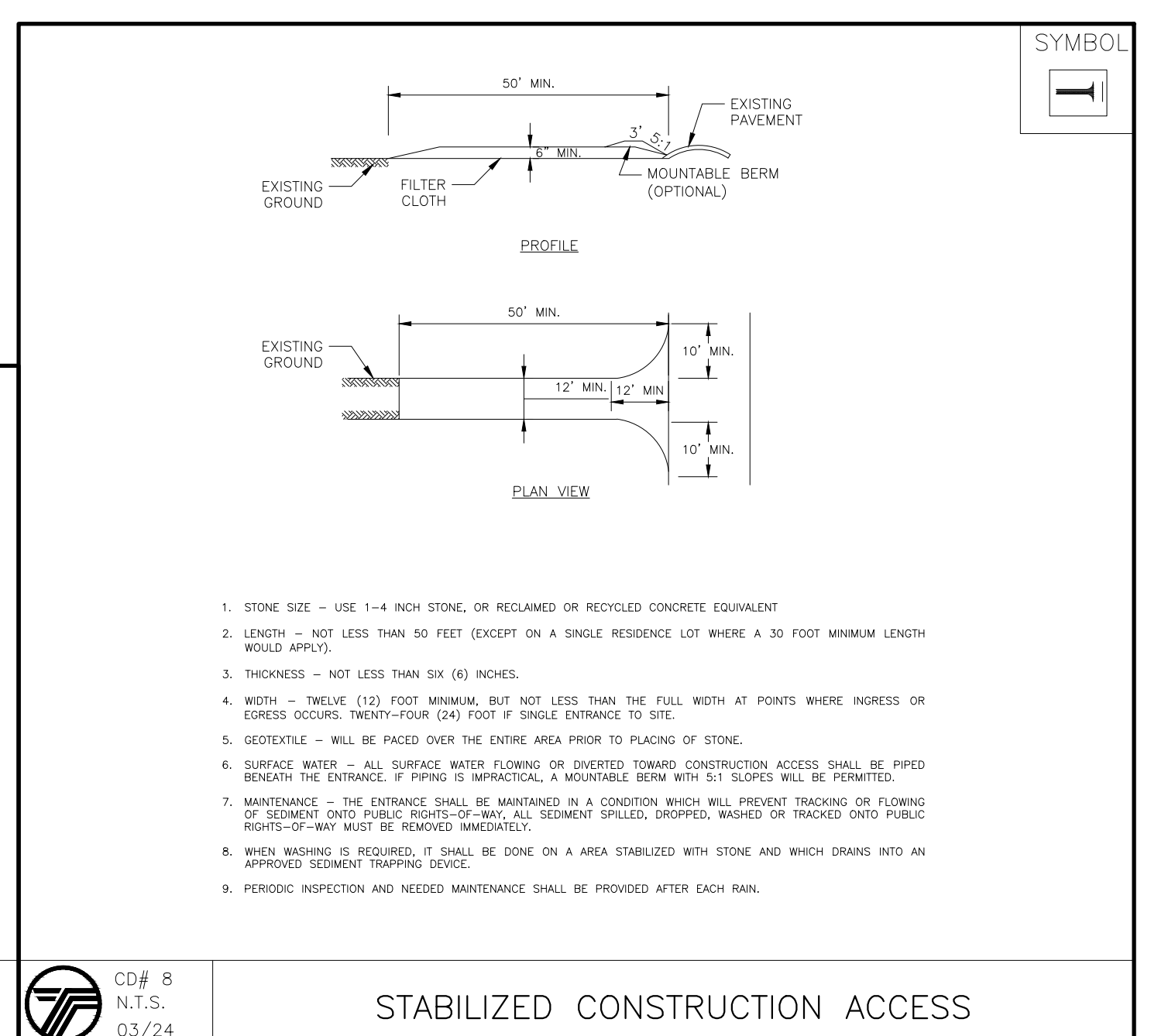
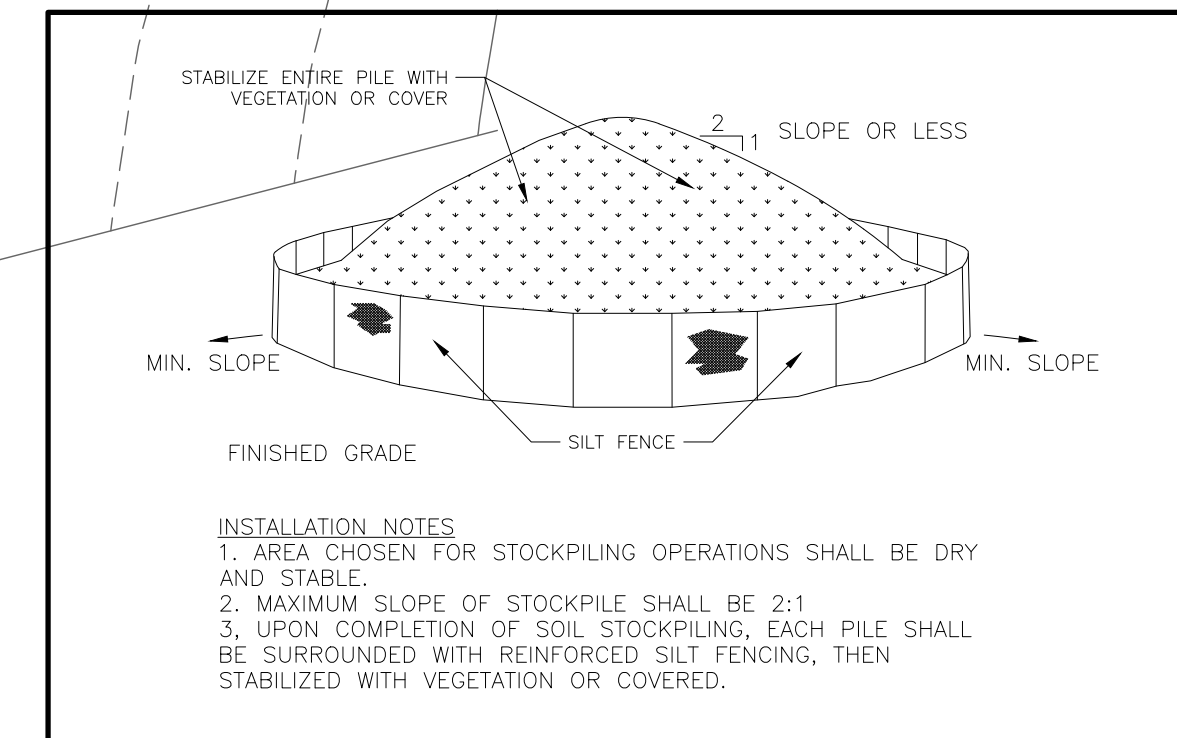

- LEGEND:**
- REINFORCED FILTER FABRIC BARRIER
 - STABILIZED CONSTRUCTION EXIT
 - INLET PROTECTION BARRIER
- NOTES:**
- AREA OF DISTURBANCE: 23,799.59 SF.

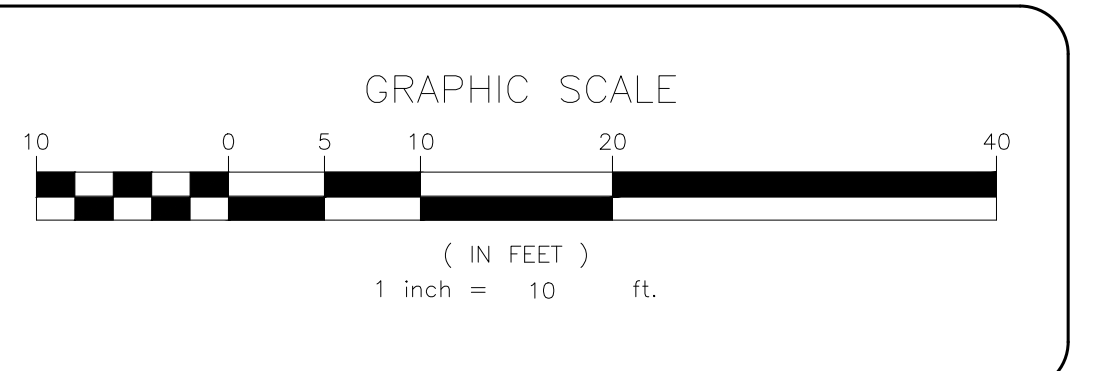

NO.	REVISION	DATE	DR/CK

KEVIN P. MAHER, P.E., M.ASCE
 4 EDGEWOOD DRIVE
 CENTRAL VALLEY, NY 10917
 LIC. 065454
 NY 845-666-0155
 NJ 732-523-2289
 E-MAIL: INFO@TERRANVC.COM
 5/28/2024
 KEVIN P. MAHER, P.E., M.ASCE LIC. 065454 DATE

SOIL EROSION & SEDIMENT CONTROL PLAN

DESIGN BY: YB	DRAWN BY: JM	CHECKED BY: KPM
---------------	--------------	-----------------

15 SEARS
 15 SEARS RD., VILLAGE OF SOUTH BLOOMING GROVE,
 ORANGE COUNTY, NY 10950
 SBL 216-1-16

DRAWING NUMBER: 06 OF 07	SCALE: 1"=10'	FILE NO.: 24177	DATE: 05/28/2024
--------------------------	---------------	-----------------	------------------

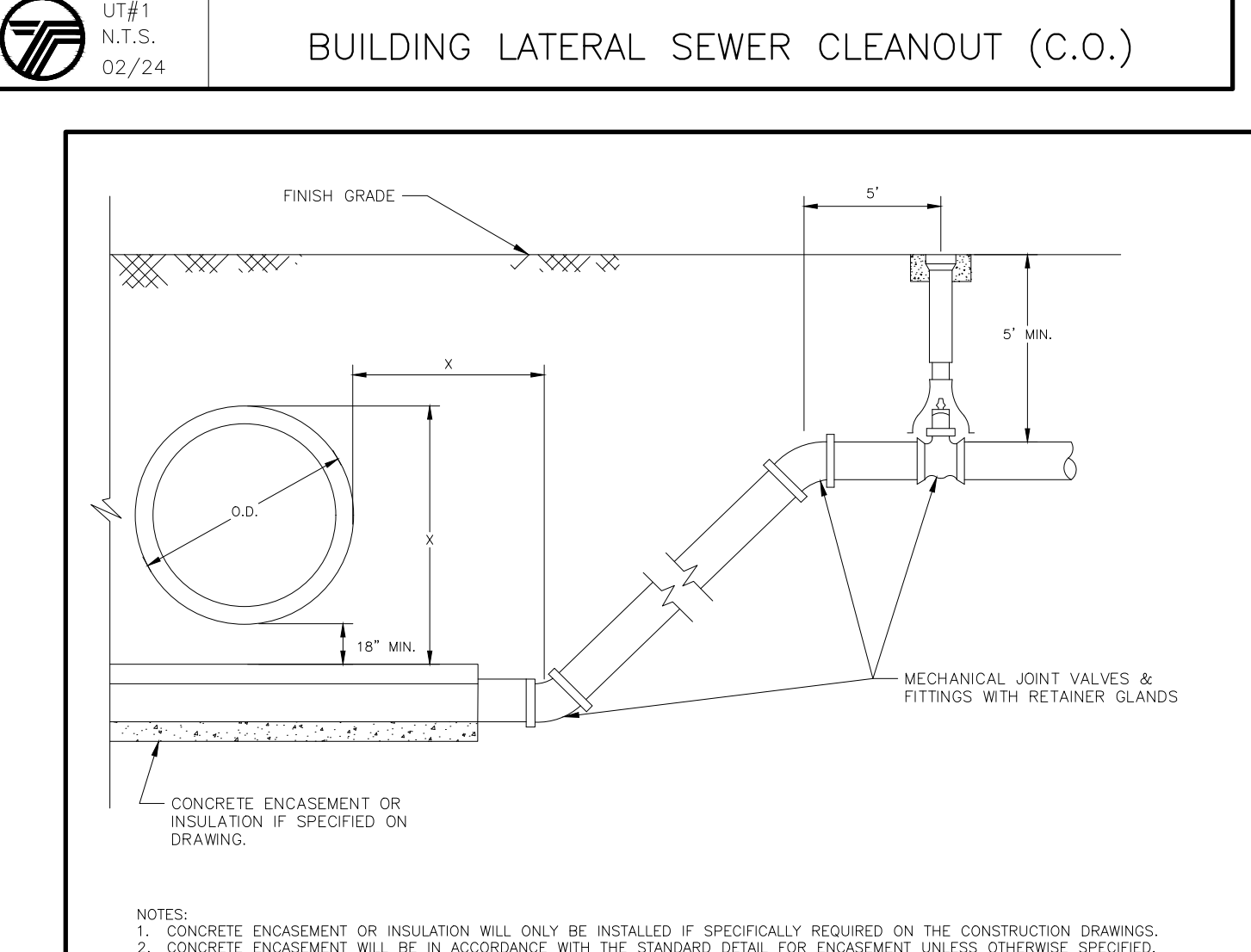
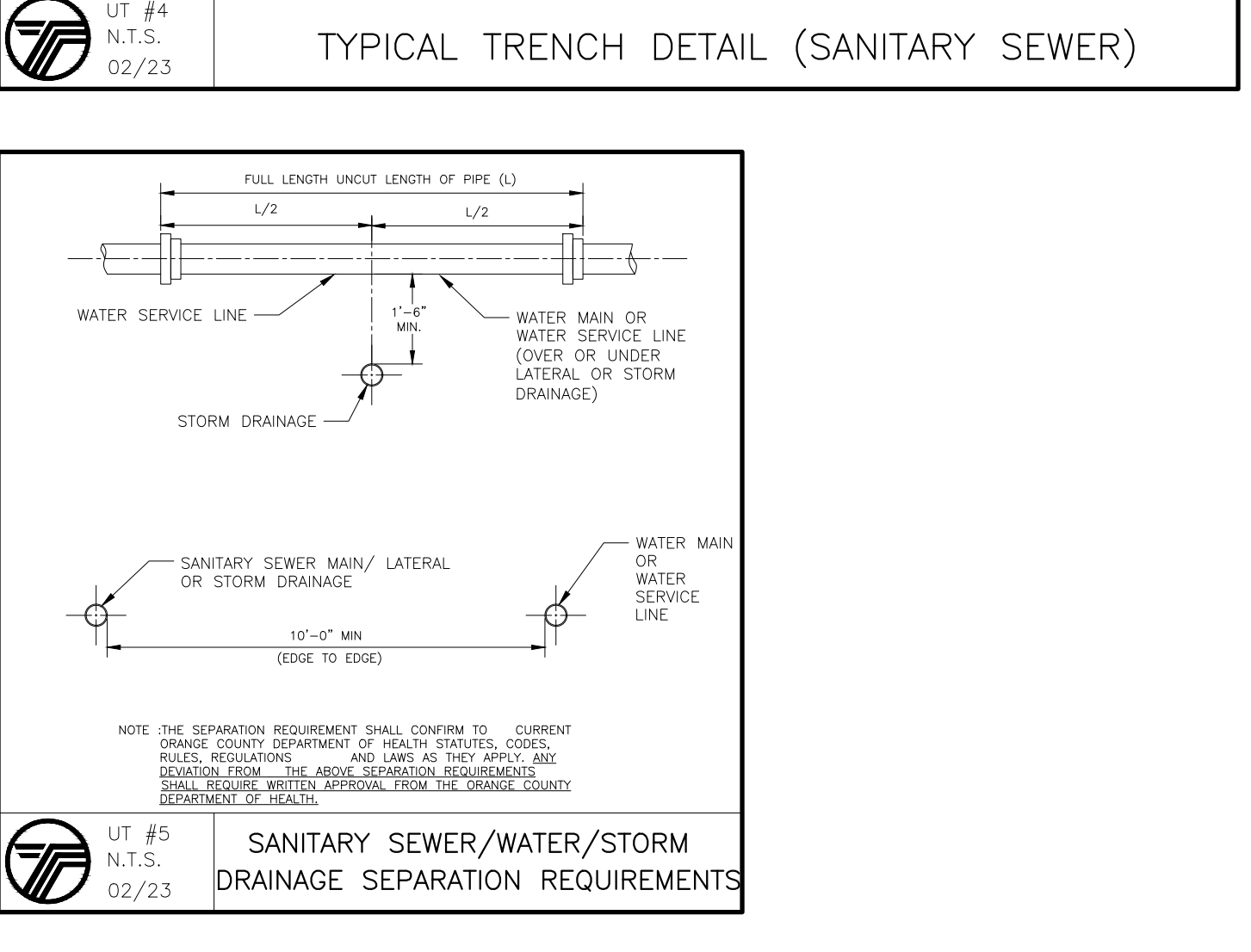
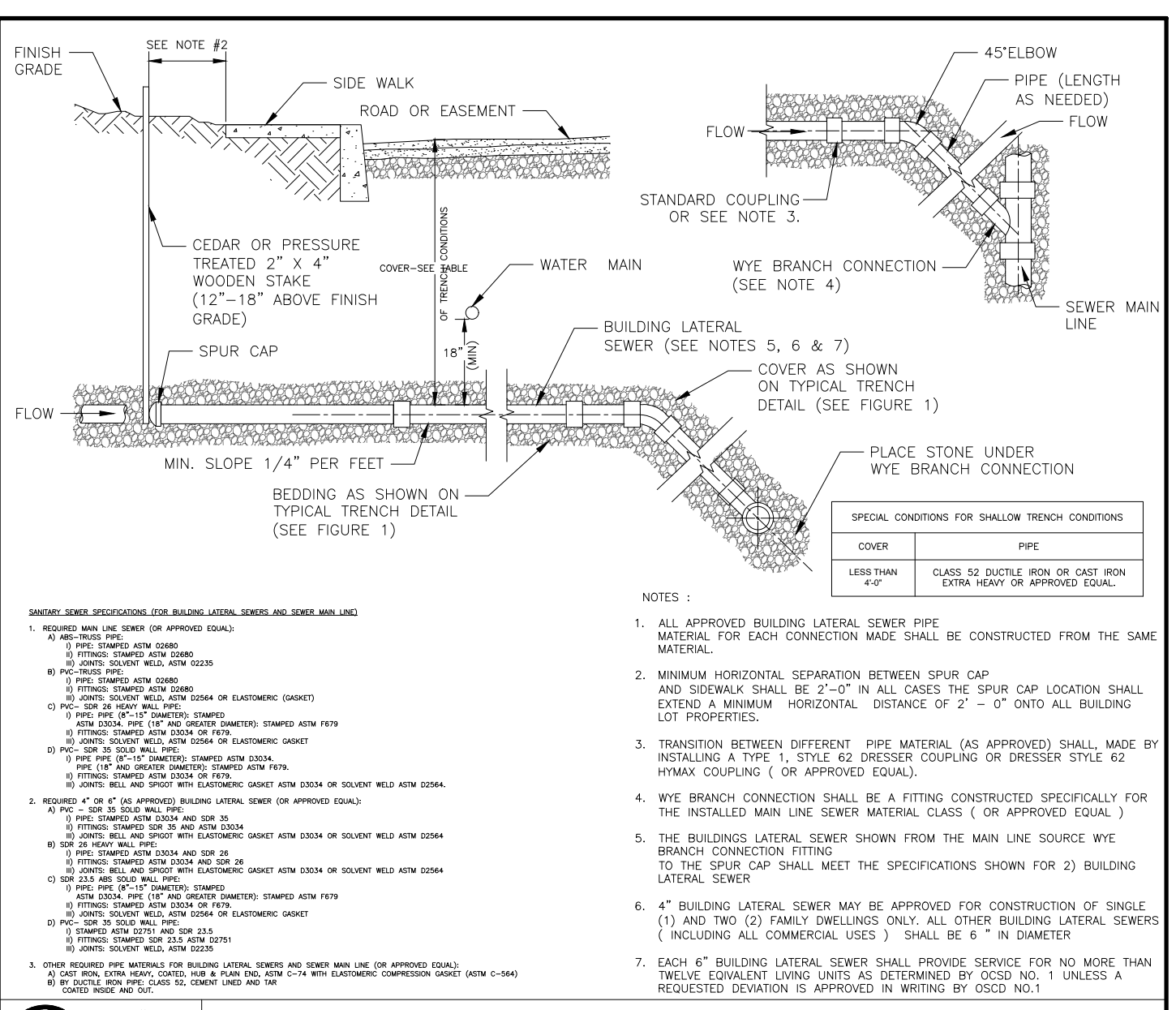
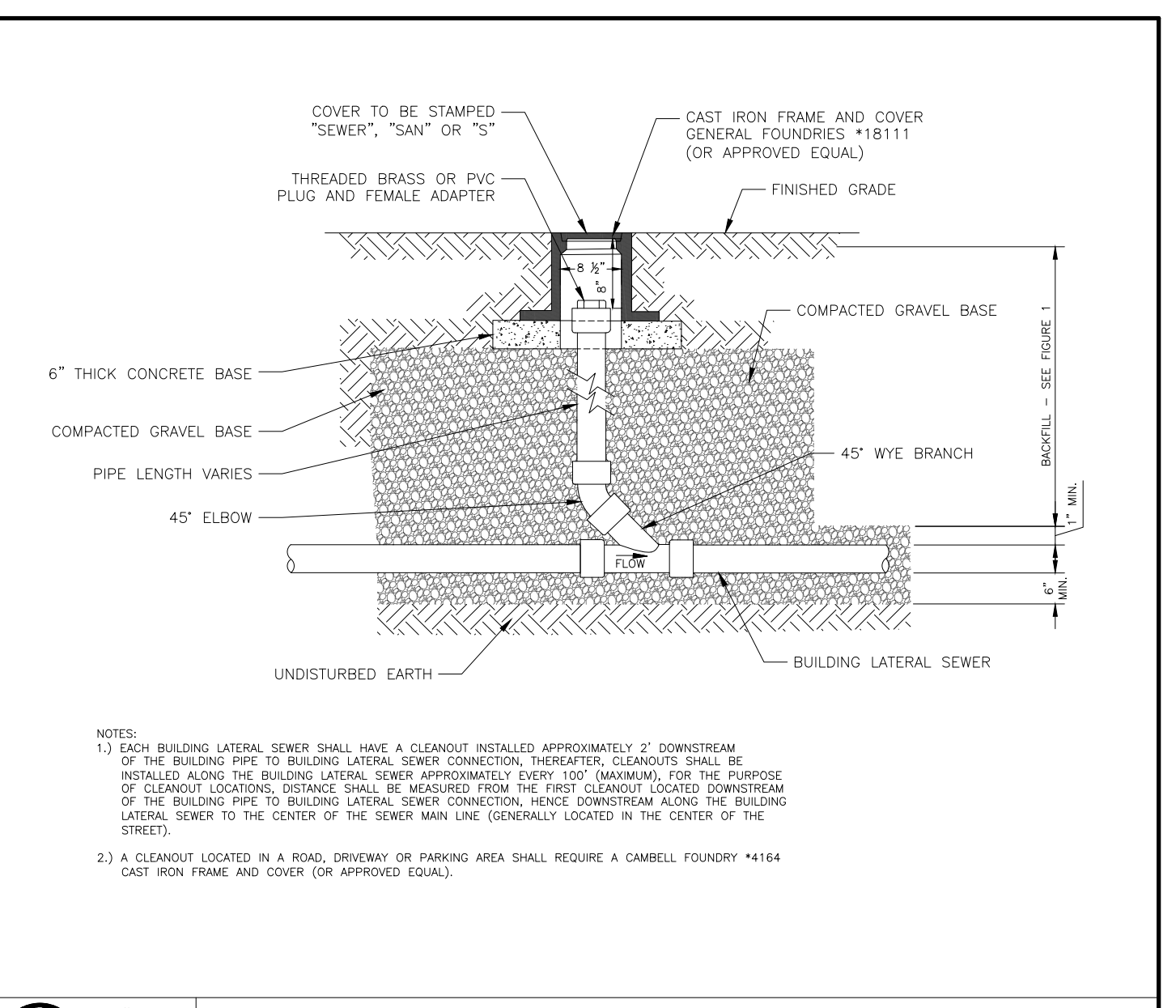
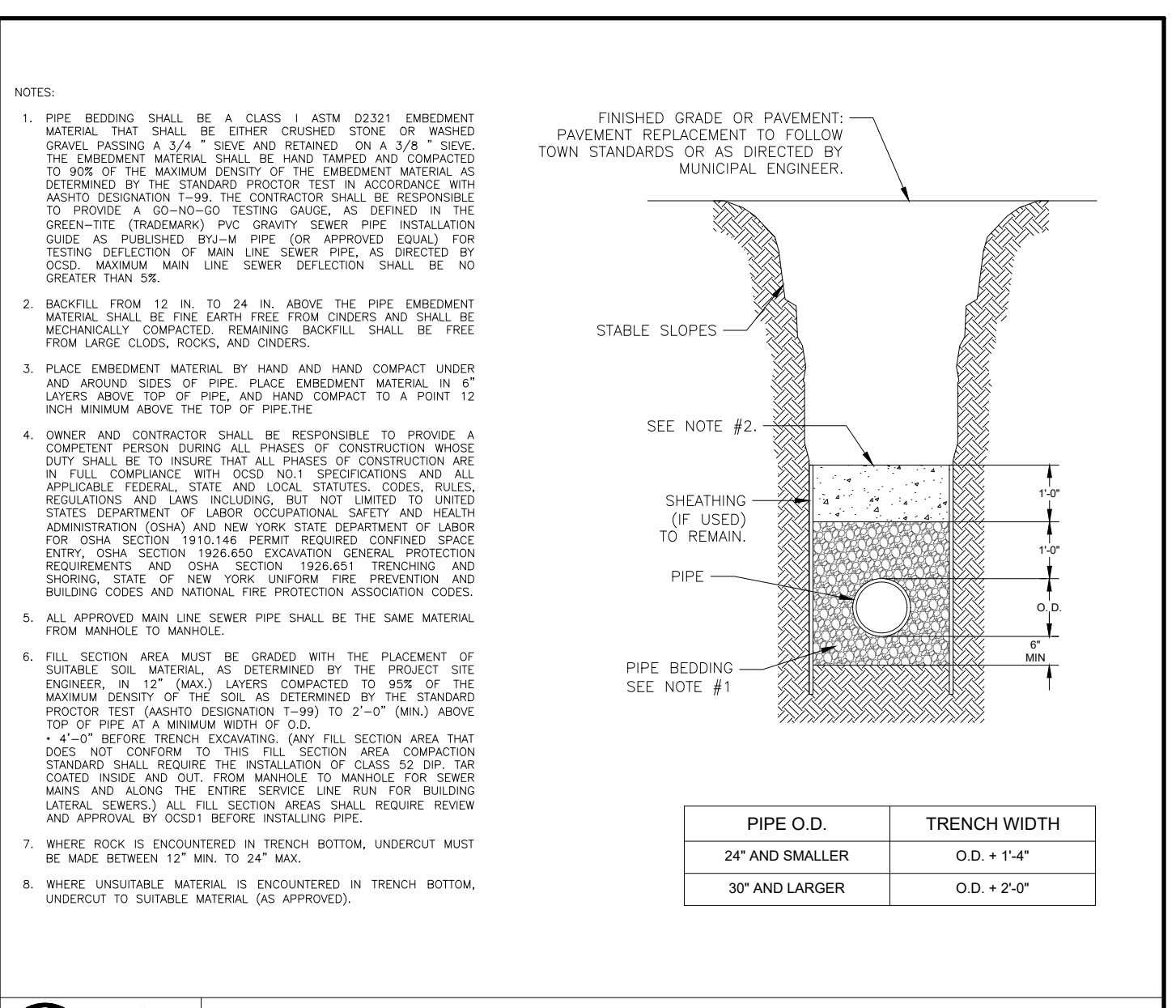
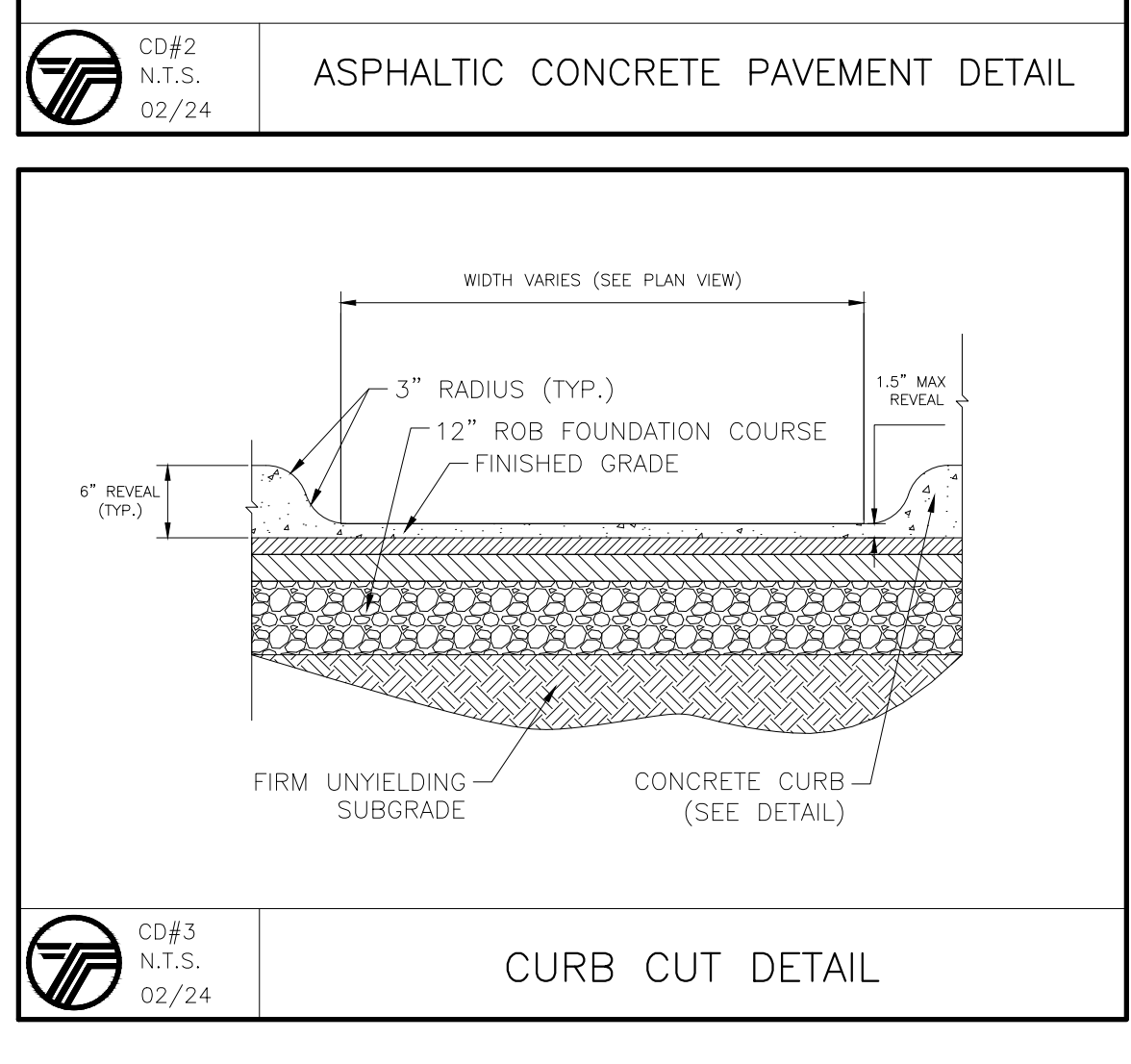
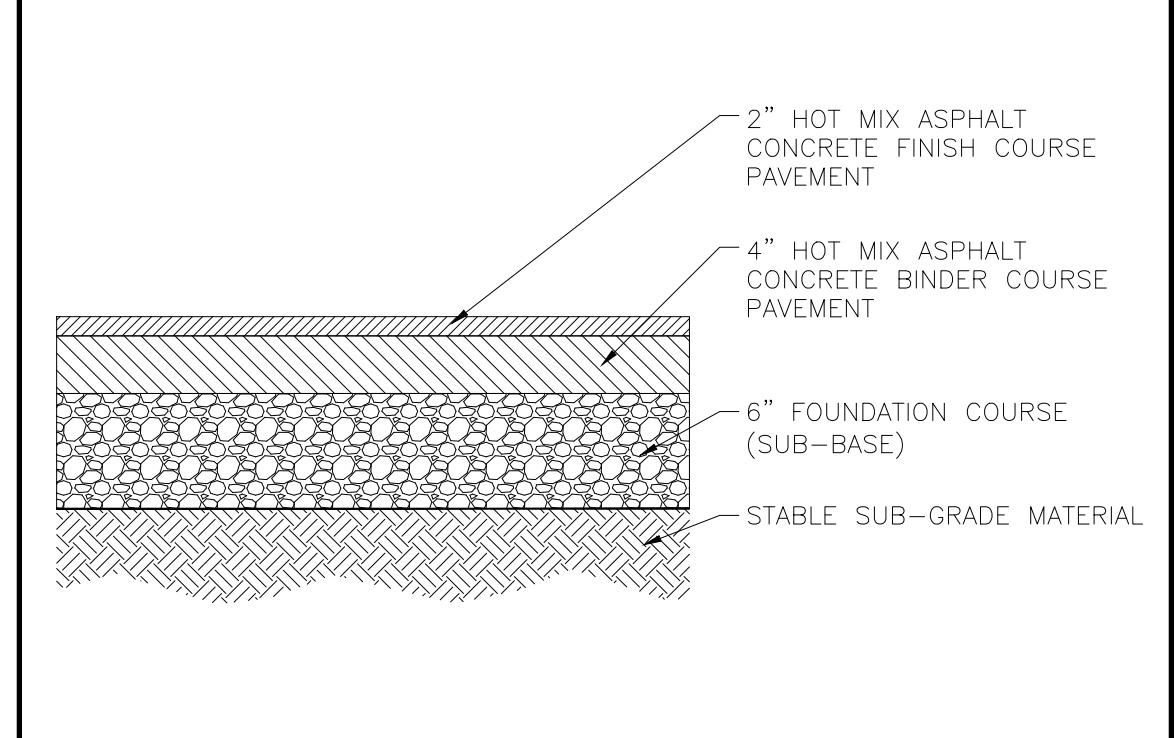
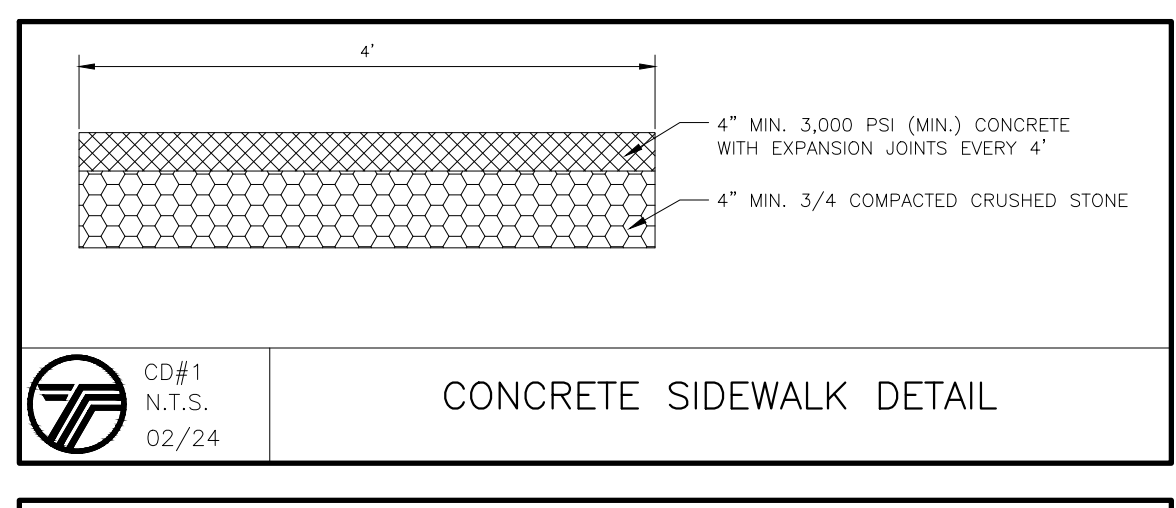

12" x 12" SQUARE CAST IRON GRATE

Material: Cast Iron
Weight: 15.30 lbs
Colors: Black (1213)

Load Recommendation Guide

Class C
• Loads of 470-525 psi
• Recommended for heavy-duty pneumatic tire vehicles and tractor trailers at speeds less than 20 mph.
• H20 rated.

12" x 12" Low Profile Adapter

Part #: 1219
Material: (HDPE) High Impact Polyethylene
Color: Black
Fits: 3", 4", 4 1/4", or 6" vertical, clean and uncoated pipe.
Requires universal outlet #1243, #1245, #1266, and #1889.
Use with 12" x 12" Grates
Weight Per Each: 1.62 lbs.
UV Inhibitor

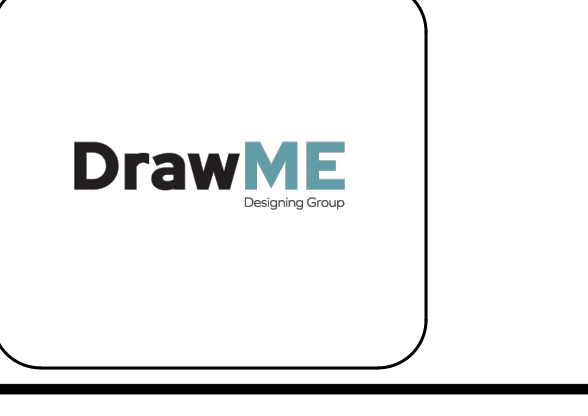
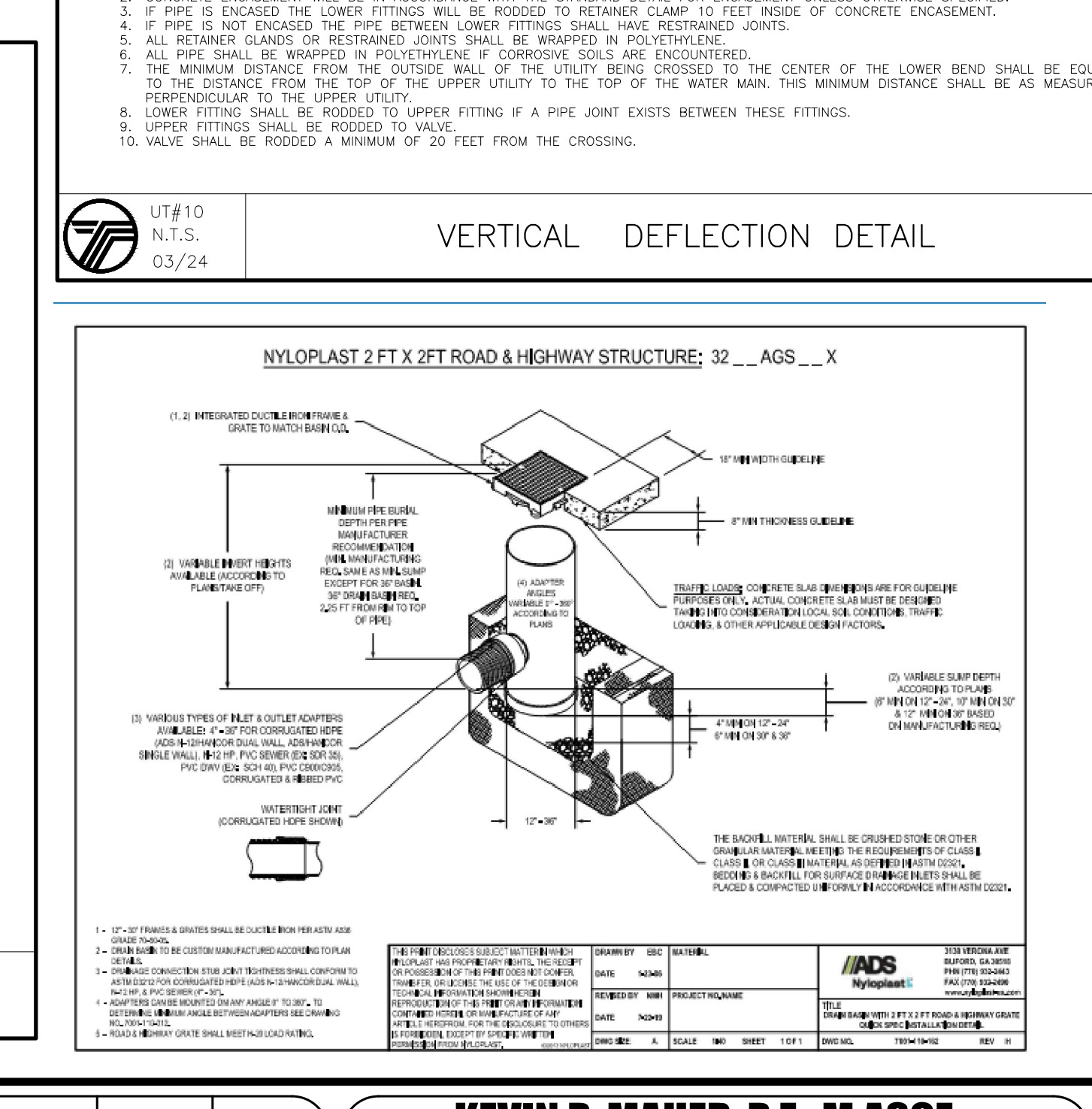
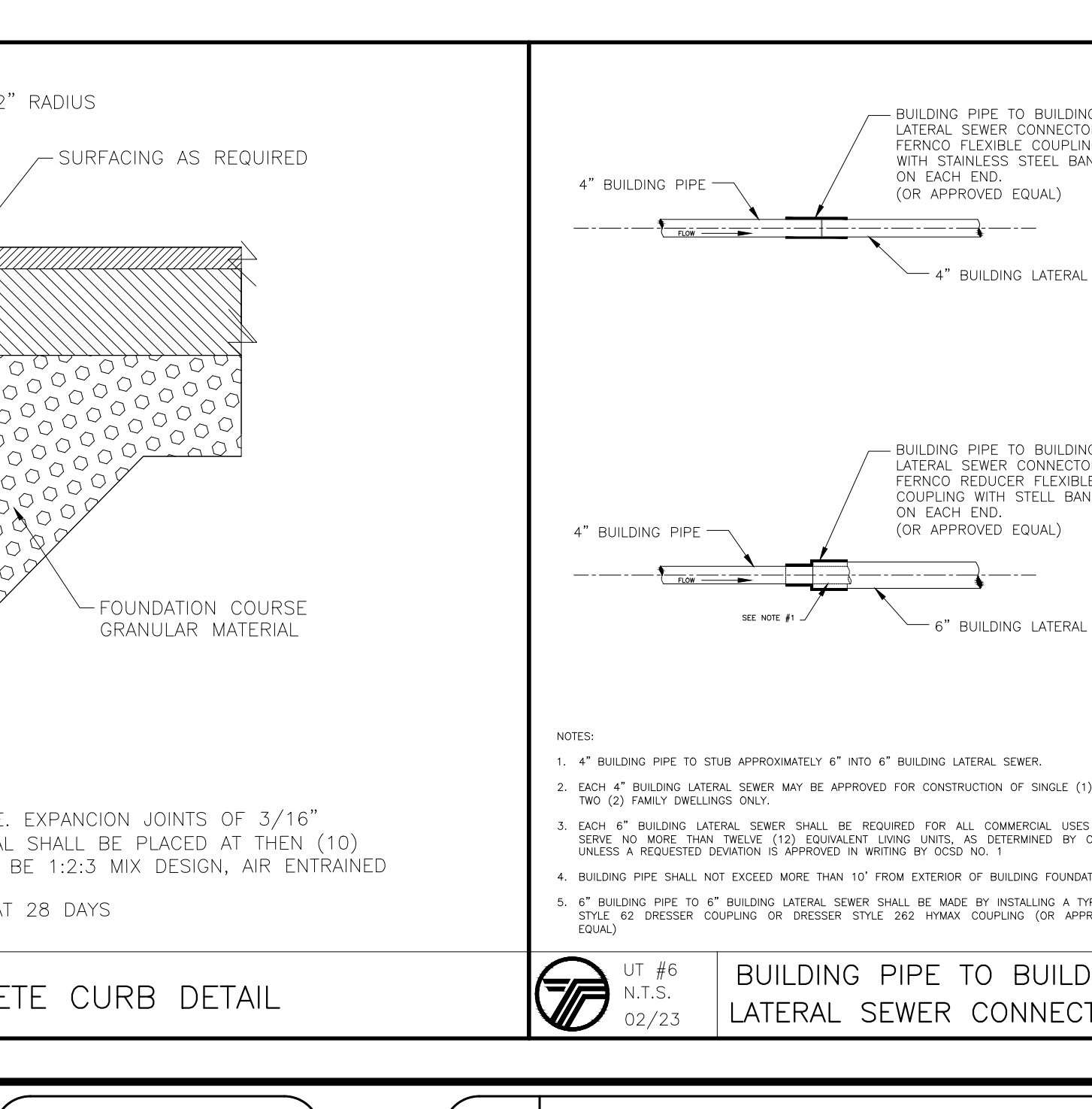
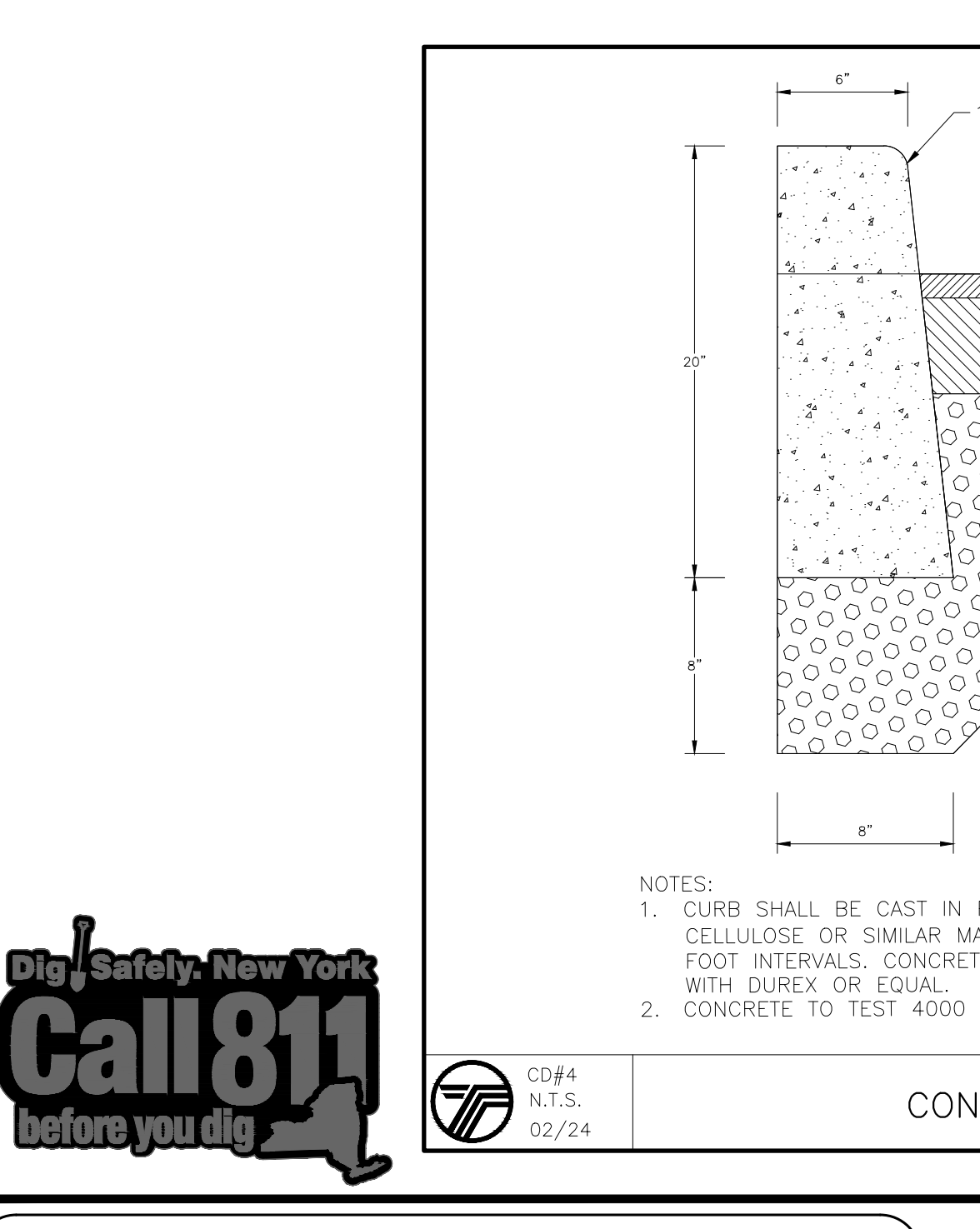

NO.	REVISION	DATE	DR/CK

KEVIN P. MAHER, P.E., MASCE

4 EDGEWOOD DRIVE
CENTRAL VALLEY, NY 10917
LIC. 065454
NY 845-666-0155
NJ 732-523-2289
E-MAIL: INFO@TERRANVC.COM

DocuSigned by:
KEVIN P. MAHER, P.E., MASCE LIC. 065454 DATE: 5/28/2024

DETAIL SHEET

DESIGN BY:	DRAWN BY:	CHECKED BY:
YB	JM	KPM

15 SEARS

15 SEARS RD., VILLAGE OF SOUTH BLOOMING GROVE,
ORANGE COUNTY, NY 10950
SBL 216-1-16

DRAWING NUMBER:	SCALE:	FILE NO.:	DATE:
07 OF 07	N.T.S.	24177	05/28/2024